

**DOCUMENT 00 91 13**

**ADDENDUM NO. 1**

Prepared By:

Graef USA Inc.  
125 South 84th Street, Suite 401  
Milwaukee, WI 53214-1470

**January 29, 2014**

For  
**W. Ryan Road (STH 100) Water Main Relay  
And  
Hydrant Relocations**

**Oak Creek Project No. 14104  
GRAEF Project No: 2013-0350.06**

This Addendum is issued to modify, explain, or correct the original Specifications and Drawings and is hereby made a part of the Contract Documents.

**ADDENDUM RECEIPT**

Acknowledge receipt of this Addendum by listing in space as provided for in Document 00 41 00 - Bid Form.

**PROJECT MANUAL**

DOCUMENT 00 41 00 – BID FORM;

DELETE existing Document 00 41 00 – BID FORM in its entirety and INSERT the attached revised Document 00 41 00 – BID FORM, dated 01/29/2014 (attached) in its place.

SECTION 01 22 00 – UNIT PRICE PAYMENT; Base Bid 1 – W. Ryan Road (STH 100) Water Main Relay Items;

DELETE Item 1: 16-inch Diameter, Class 235, Poly Vinyl Chloride (PVC), Water Main Installation (Granular Backfill) in its entirety and INSERT the following:

“Item 1: 16-Inch Diameter, Class 52 Ductile Iron, Double Polywrapped, Water Main Installation (Granular Backfill)”

**01/29/2014**

**00 91 13-1**

**2013-0350.06**

DELETE Bullet Point under Item 1, that states “installation of PVC piping” and INSERT the following:

“Installation of ductile iron pipe”

SECTION 01 22 00 – UNIT PRICE PAYMENT; Base Bid 2 – W. Ryan Road (STH 100) Hydrant Relocation Items;

Under Item 1: Hydrant Relocation:

DELETE the Bullet Point that states “provide and install hydrant extensions as required” in its entirety.

DELETE last Bullet Point the states “installation of tracer wire and tracer wire access boxes” in its entirety.

Under Item 2: Hydrant Alterations:

DELETE the first Bullet Point that states “excavate and remove existing hydrant, valve and pipe” in its entirety and INSERT “excavate and remove existing hydrant and pipe” in its place.

DELETE the Bullet Point that states “provide and install hydrant extensions as required” in its entirety.

DELETE the Bullet Point that states “provide 6-inch gate valve and related fittings, where no auxiliary valve currently exists” and INSERT “provide related fittings” in its place.

DELETE the last Bullet Point that states “installation of tracer wire and tracer wire access boxes” in its entirety.

SECTION 33 05 06 - POLYVINYL CHLORIDE (PVC) PRESSURE PIPE, Article 2.4;

INSERT new Paragraph E to read as follows:

“E. Install 2-foot long 5/8-inch diameter copper grounding rod attached to tracer wire with hex head ground rod clamp manufactured by Storm Copper Components Co. or approved equal at all connections to existing main for future utility locating.”

SECTION 33 05 19 - PRESSURE PIPE RESTRAINTS, Article 3.3

INSERT new Paragraph D to read as follows:

D. “Restrain all existing un-restrained hydrant auxiliary valves and existing mainline valves exposed during water main installation.”

SECTION 33 13 16 – CORROSION CONTROL FOR PIPE AND FITTINGS; Article 2.1, Paragraph B.;

DELETE the Detail Drawing “A” and INSERT Detail Drawing “E” in its place.

CLARIFICATION: All Ductile Iron Piping for Water Relay shall be double wrapped with polyethylene and all valves, tees, crosses, bends and related ductile iron fittings shall be triple wrapped with polyethylene.

### **DRAWINGS**

Clarification: Proposed hydrant leads on Drawings are approximate only. Additional hydrant lead length required to meet proposed hydrant locations shall be incidental to hydrant unit bid item.

DELETE existing Drawings, 13 pages, and REPLACE with revised attached Drawings, 13 pages.

**END OF ADDENDUM NO. 1**

**DOCUMENT 00 41 00**

**BID FORM**

**Water Main and Appurtenances for  
W. Ryan Road (STH 100) Water Main Relay  
and  
Hydrant Relocations  
for  
Oak Creek Water and Sewer Utility**

**Project No. 14101**

**BID DATE: Friday, January 31, 2014**

Sealed bids will be received by Owner until 9:00 a.m. on Friday, January 31, 2014, at the office of the Oak Creek Water and Sewer Utility, 170 West Drexel Avenue, Oak Creek, WI. 53154.

**ARTICLE 1 BID RECIPIENT**

1.01 This Bid is submitted to the OWNER:

**Oak Creek Water and Sewer Utility  
170 West Drexel Avenue  
Oak Creek, WI 53154**

1.02 The undersigned BIDDER proposes and agrees, if this Bid is accepted, to enter into an Agreement with OWNER in the form included in the Bidding Documents to perform all Work as specified or indicated in the Bidding Documents for the prices and within the times indicated in this Bid and in accordance with the other terms and conditions of the Bidding Documents.

**ARTICLE 2 BIDDER'S ACKNOWLEDGEMENTS**

2.01 BIDDER accepts all of the terms and conditions of the Instructions to Bidders, including without limitation those dealing with the disposition of bid security. This Bid will remain subject to acceptance for thirty (30) days after the day of Bid opening, or for such longer period of time that BIDDER may agree to in writing upon request of OWNER.

**ARTICLE 3 BIDDER'S REPRESENTATIONS**

3.01 In submitting this Bid, BIDDER represents that:

- A. BIDDER has examined and carefully studied the Bidding Documents, and the following Addenda, receipt of all which is hereby acknowledged.

**01/29/2014**

**00 41 00 - 1**

**Bid Form**

**Addendum No. 1**

**© 2014 – Oak Creek Water and Sewer Utility**

Date

Number

- B. BIDDER has visited the site and become familiar and is satisfied as to the general, local and Site conditions that may affect cost, progress, and performance of the Work.
- C. BIDDER is familiar with and satisfied as to all federal, state and local Laws and Regulations that may affect cost, progress, and performance of the Work.
- D. BIDDER has carefully studied all: (1) reports or explorations and tests of subsurface conditions at or contiguous to the Site and all drawings of physical conditions in or relating to existing surface of subsurface structures at or contiguous to the Site (except Underground Facilities) which have been identified in SC-4.02, and (2) reports and drawings of Hazardous Environmental Conditions, if any, that have been identified in SC-4.06.
- E. BIDDER has obtained and carefully studied (or accepts the consequences for not doing so) all additional or supplementary examinations, investigations, explorations, test, studies, and data concerning conditions (surface, subsurface, and Underground Facilities) at or contiguous to the Site which may affect the cost, progress, or performance of the Work or which relate to any aspect of the means, methods, techniques, sequences, and procedures of construction to be employed by BIDDER, including applying the specific means, methods, techniques, sequences, and procedures of construction expressly required by the Bidding Documents to be employed by the BIDDER, and safety precautions and programs incident thereto.
- F. BIDDER does not consider that any further examinations, investigations, explorations, tests, studies, or data are necessary for the determination of this Bid for performance of the Work at the price(s) bid and within the times and in accordance with the other terms and conditions of the Bidding Documents.
- G. BIDDER is aware of the general nature of work to be performed by OWNER and others at the Site that relates to the Work as indicated in the Bidding Documents.
- H. BIDDER has correlated the information known to BIDDER, information and observations obtained from visits to the Site, reports and drawings identified in the Bidding Documents, and all additional examinations, investigations, explorations, tests, studies, and data with the Bidding Documents.
- I. BIDDER has given OWNER written notice of all conflicts, errors, ambiguities, or discrepancies that BIDDER has discovered in the Bidding Documents, and the written resolution thereof by OWNER is acceptable to BIDDER.

01/29/2014

00 41 00 - 2

Bid Form

Addendum No. 1

© 2014 – Oak Creek Water and Sewer Utility

J. The Bidding Documents are generally sufficient to indicate and convey understanding of all terms and conditions for performance of the Work for which this Bid is submitted.

K. BIDDER will submit written evidence of its authority to do business in the state where the Project is located not later than the date of execution of the Agreement.

**ARTICLE 4 FURTHER REPRESENTATIONS**

4.01 BIDDER further represents that:

- A. This Bid is genuine and not made in the interest of or on behalf of any undisclosed individual or entity and is not submitted in conformity with any agreement or rules of any group, association, organization, or corporation;
- B. BIDDER has not directly or indirectly induced or solicited any other Bidder to submit a false or sham Bid;
- C. BIDDER has not solicited or induced any individual or entity to refrain from bidding; and
- D. BIDDER has not sought by collusion to obtain for itself any advantage over any other Bidder or over OWNER.

**ARTICLE 5 BASIS OF BID**

5.01 BIDDER will complete the Work in accordance with the Bidding Documents for the following price(s):

**W. Ryan Road (STH 100) Water Main Relay – Base Bid No. 1**

<b>Item No.</b>	<b>Item Description</b>	<b>Bid Quantity</b>	<b>Units</b>	<b>Unit Price (Words)</b>	<b>Unit Price (Numeric Figure)</b>	<b>Total Price</b>
1	16" Class 52 Ductile Iron, Double Polywrapped, Water Main with granular backfill, full depth sawcutting, concrete pavement removal, asphalt pavement replacement, asphalt curb and gutter replacement, lawn restoration	232	LF			
2	16-inch Butterfly Valve	1	EA			
3	Permanent 1-inch Air Release Valve	1	EA			

Item No.	Item Description	Bid Quantity	Units	Unit Price (Words)	Unit Price (Numeric Figure)	Total Price
4	Connect to Existing 16" Water Main. Provide and install anode protection.	2	EA			
5	Hydrant, Lead and 6-inch Gate Valve and Grade Extensions	1	EA			
6	Erosion Control	1	LS			
7	Traffic Control	1	LS			
8	Salvage and Delivery of Existing Hydrants and Valves	1	LS			

**BASE BID NO. 1: TOTAL (ITEMS 1 – 8) INCLUSIVE:** \_\_\_\_\_

\_\_\_\_\_ (\$ \_\_\_\_\_)  
 (Use Words) (Figures)

**W. Ryan Road (STH 100) Hydrant Relocations – Base Bid No. 2**

Item No.	Item Description	Bid Quantity	Units	Unit Price (Words)	Unit Price (Numeric Figure)	Total Price
1	Hydrant Relocation, including removing existing hydrants, valves, and pipe as needed, furnishing and installing new 6.0 foot hydrants, 6" C900 CL 200 DR-14 restrained water main pipe, 6" gate valve, fittings, tapping sleeves, live tap to existing water main, buttresses, excavation, insulation, granular backfill and asphalt restoration as designated on the Drawings	16	EA			

Item No.	Item Description	Bid Quantity	Units	Unit Price (Words)	Unit Price (Numeric Figure)	Total Price
2	Hydrant alteration, including removing existing hydrants, valves, and pipe as needed, furnishing and installing new 6.0 foot hydrants, 6" C900 CL 200 DR-14 PVC restrained water main pipe, fittings, provide and install anode protection, temporary plugs, caps, buttresses, flushing vents for testing and sampling, excavation, insulation, granular backfill and asphalt restoration as designated on the Drawings.	7	EA			
3	Salvage and Delivery of Existing Hydrants and Valves	1	LS			
4	Erosion Control	1	LS			
5	Traffic Control	1	LS			
6	Provide and Install Hydrant Grade Extensions	23	VF			

**BASE BID NO. 2: TOTAL (ITEMS 1 – 6) INCLUSIVE:** \_\_\_\_\_

\_\_\_\_\_ (\$ \_\_\_\_\_)  
 (Use Words) (Figures)

**COMBINED TOTAL OF BASE BID NO. 1 AND BASE BID NO. 2 INCLUSIVE:** \_\_\_\_\_

\_\_\_\_\_ (\$ \_\_\_\_\_)  
 (Use Words) (Figures)

**Bids will be selected based upon the combined total of Base Bids No. 1 and No. 2.**

Separate Base Bid No.1 and Base Bid No.2 amounts are for Utility knowledge only.

Unit Prices have been computed in accordance with Paragraph 11.03B of the General Conditions.

BIDDER acknowledges that estimated quantities are not guaranteed, and are solely for the purpose of comparison of Bids, and final payment for all Unit Price Bid items will be based on actual quantities, determined as provided in the Contract Documents.

**ARTICLE 6 SUBCONTRACTORS LIST**

BIDDER shall identify and submit the following list of Subcontractors with their bid:

<u>Excavation Subcontractor</u>	_____
<u>Asphalt Paving Subcontractor</u>	_____
<u>Landscaping Subcontractor</u>	_____
_____	_____
_____	_____

BIDDER shall identify and list the Supplier(s) of the following items of major materials and products upon which this bid is based, with their bid.

<u>Water Main Piping Manufacturer/Supplier</u>	_____
<u>Water Main Valve Manufacturer/Supplier</u>	_____
_____	_____
_____	_____

**ARTICLE 7 TIME OF COMPLETION**

7.01 BIDDER agrees that the Work will be substantially complete on or before **April 4, 2014** and completed and ready for final payment in accordance with Paragraph 14.07B of the General Conditions on or before **April 12, 2014**.

7.02 BIDDER accepts the provisions of the Agreement as to liquidated damages in the event of failure to complete the Work within the Contract Times.

**ARTICLE 8 BIDDING DOCUMENTS**

8.01 The Drawings and Specifications upon which this proposal is based are as follows:

- A. Specifications bound along with this proposal form into the Project Manual dated January 16, 2014.
- B. Drawings dated January 16, 2014, and consisting of the following:  
Complete Drawing set re-issued on January 29, 2014 attached to Addendum No. 1.

<u>Sheet No.</u>	<u>Description</u>
01	Cover Sheet
02	Index Sheet
03 - 06	Proposed Hydrant Alterations
07	Proposed Water Main Relay
08 - 13	Traffic Control

**ARTICLE 9 ATTACHMENTS TO THIS BID**

9.01 The following documents are attached to and made a condition of this Bid:

- A. Required Bid Security in the form of \_\_\_\_\_.
- B. List of proposed Subcontractors and Suppliers.
- C. Affidavit of Non-Collusion.
- D. List other documents as pertinent:

\_\_\_\_\_  
\_\_\_\_\_  
\_\_\_\_\_  
\_\_\_\_\_  
\_\_\_\_\_

**ARTICLE 10 BIDDER'S CONTACT**

10.01 Communications concerning the preparation of this Bid shall be addressed to the following person(s) in the Bidder's Office:

---

---

---

---

---

**ARTICLE 11 DEFINED TERMS**

11.01 The terms used in this Bid with initial capital letters have the meanings stated in the Instructions to Bidders, the General Conditions, and the Supplementary Conditions.

SUBMITTED ON \_\_\_\_\_, 20\_\_.

An Individual

By \_\_\_\_\_ (SEAL)  
(Individual's Name)

doing business as \_\_\_\_\_

Business Address: \_\_\_\_\_

\_\_\_\_\_

Phone and Fax No.: \_\_\_\_\_

A Partnership

By \_\_\_\_\_ (SEAL)  
(Firm Name)

\_\_\_\_\_  
(General Partner)

Business Address: \_\_\_\_\_

\_\_\_\_\_

Phone and Fax No.: \_\_\_\_\_

A Corporation

By \_\_\_\_\_  
(Corporation Name)

\_\_\_\_\_  
(State of Incorporation)

By \_\_\_\_\_  
(Name of Person Authorized to Sign)

\_\_\_\_\_  
(Title)

(Corporate Seal)

Attest \_\_\_\_\_  
(Secretary)

Business Address: \_\_\_\_\_  
\_\_\_\_\_

Phone and Fax No.: \_\_\_\_\_

A Joint Venture

By \_\_\_\_\_  
(Name)

\_\_\_\_\_  
(Address)

By \_\_\_\_\_  
(Name)

\_\_\_\_\_  
(Address)

Phone and Fax No. \_\_\_\_\_

(Each member firm of the joint venture must sign. The manner of signing for each individual, partnership, and corporation that is a party to the joint venture should be in the manner indicated above.)

**END OF DOCUMENT**

**LEGEND AND ABBREVIATIONS**

▲	TRaverse POINT	○	TILE	~~~~~	EDGE OF BRUSH
□	POWER POLE	PVC P	PVC PIPE	~~~~~	EDGE OF WOODS
⊗	LIGHT POLE	○ CO	CLEANOUT	⊖	HEDGE ROW
○ FLAG	FLAG POLE	R BAR	REBAR	⊖	RIP RAP
○	MANHOLE	BM.	BENCH MARK	—○—	CHAIN LINK FENCE
⊕	STORM INLET	○TMH	TELEPHONE MANHOLE	—○—	GUARD RAIL
⊗	WATER VALVE	⊗SV	GAS SERVICE VALVE	—TV—	BURIED CABLE TV
⊗	GAS VALVE	⊗WSV	WATER SERVICE VALVE	—E—	BURIED ELECTRIC LINE
⊗	FIRE HYDRANT	⊕	CATCH BASIN	—O—	OVERHEAD ELECTRIC LINE
⊗	MAIL BOX	⊗	CONIFEROUS TREE	—G—	BURIED GAS MAIN
⊗	TELEPHONE PEDESTAL	⊗	STUMP	—FM—	BURIED FORCE MAIN
⊗	CONTROL BOX	⊗	BUSH	—L—	BURIED STREET LIGHTING
⊗	TRAFFIC SIGNAL	○ METAL	METAL POST	—SAN—	BURIED SANITARY SEWER
○ GUY	GUY WIRE	⊗	HANDHOLE	—MIS—	BURIED MIS SEWER
⊕	MONUMENT	⊗	MISCELLANEOUS METER	—STM—	BURIED STORM SEWER
○ 1"IP	1" IRON PIPE	○ WOOD	WOOD POST	—T—	BURIED TELEPHONE LINE
○ 2"IP	2" IRON PIPE	⊗	ABANDONED POLE	—W—	BURIED WATER MAIN
○ VENT	VENT PIPE	○ YL	YARD LIGHT	—A—	EXISTING PROPERTY LINE
⊗	PULL BOX	⊗	SIGN	—R/W—	EXISTING RIGHT OF WAY
A/C	AIR CONDITIONER	⊗	INLET PROTECTION		
⊗	DECIDUOUS TREE	○○○	CULVERT PIPE DITCH CHECK		

ASPH.	ASPHALT	I.E.	INVERT ELEVATION
BSM'T.	BASEMENT	I.P.	IRON PIPE
BIT.	BITUMINOUS	LAT.	LATERAL
CB.	CATCHBASIN	MH.	MANHOLE
C/L	CENTERLINE	M.J.	MECHANICAL JOINT
CIPP	CURED-IN-PLACE PIPE	PAV.T.	PAVEMENT
COMM	COMMUNICATIONS	PROP.	PROPOSED
CONC.	CONCRETE	PVC	POLYVINYL CHLORIDE
CMP	CORRUGATED METAL PIPE	PVC P.	PVC PIPE
CMPA	CORRUGATED METAL PIPE ARCH	OH	OVERHEAD
C&G	CURB & GUTTER	R. BAR	REBAR
DRAIN T.	DRAIN TILE	REQ'D.	REQUIRED
D.I.P.	DUCTILE IRON PIPE	R.J.	RESTRAINED JOINT
DWY.	DRIVEWAY	R.O.W.	RIGHT-OF-WAY
ECC.	ECCENTRIC	SAN.	SANITARY
ELEC.	ELECTRIC	S.	SLOPE
EXIST.	EXISTING	STL.	STEEL
EX.	EXISTING	STM.	STORM
F.F.	FIRST FLOOR	SUMP D.	SUMP DISCHARGE
FM.	FORCE MAIN	S/W	SIDE WALK
F.O.C.	FACE OF CURB	TELE	TELEPHONE
G.V.	GAS VALVE	TYP.	TYPICAL
GR.	GRAVEL	VENT P.	VENT PIPE
G.W.	GUY WIRE	WM.	WATER MAIN
HYD.	HYDRANT	W.V.	WATER VALVE
INL.	INLET	W/	WITH

**SHEET INDEX**

Sheet No.	01	COVER SHEET
Sheet No.	02	INDEX SHEET
Sheet No.	03-06	PROPOSED HYDRANT ALTERATIONS
Sheet No.	07	PROPOSED WATER MAIN RELAY
Sheet No.	08-13	TRAFFIC CONTROL

TOTAL SHEETS = 13

# CITY OF OAK CREEK

## WATER AND SEWER UTILITY

### W. RYAN ROAD (STH 100) WATER MAIN RELAY AND HYDRANT RELOCATIONS

PROJECT NUMBER  
**14104**

**JANUARY 16, 2014**

PROJECT LOCATION  
IN: W. RYAN ROAD (STH 100)  
FROM: S. 27TH STREET (STH 241)  
TO: S. HOWELL AVENUE (STH 38)

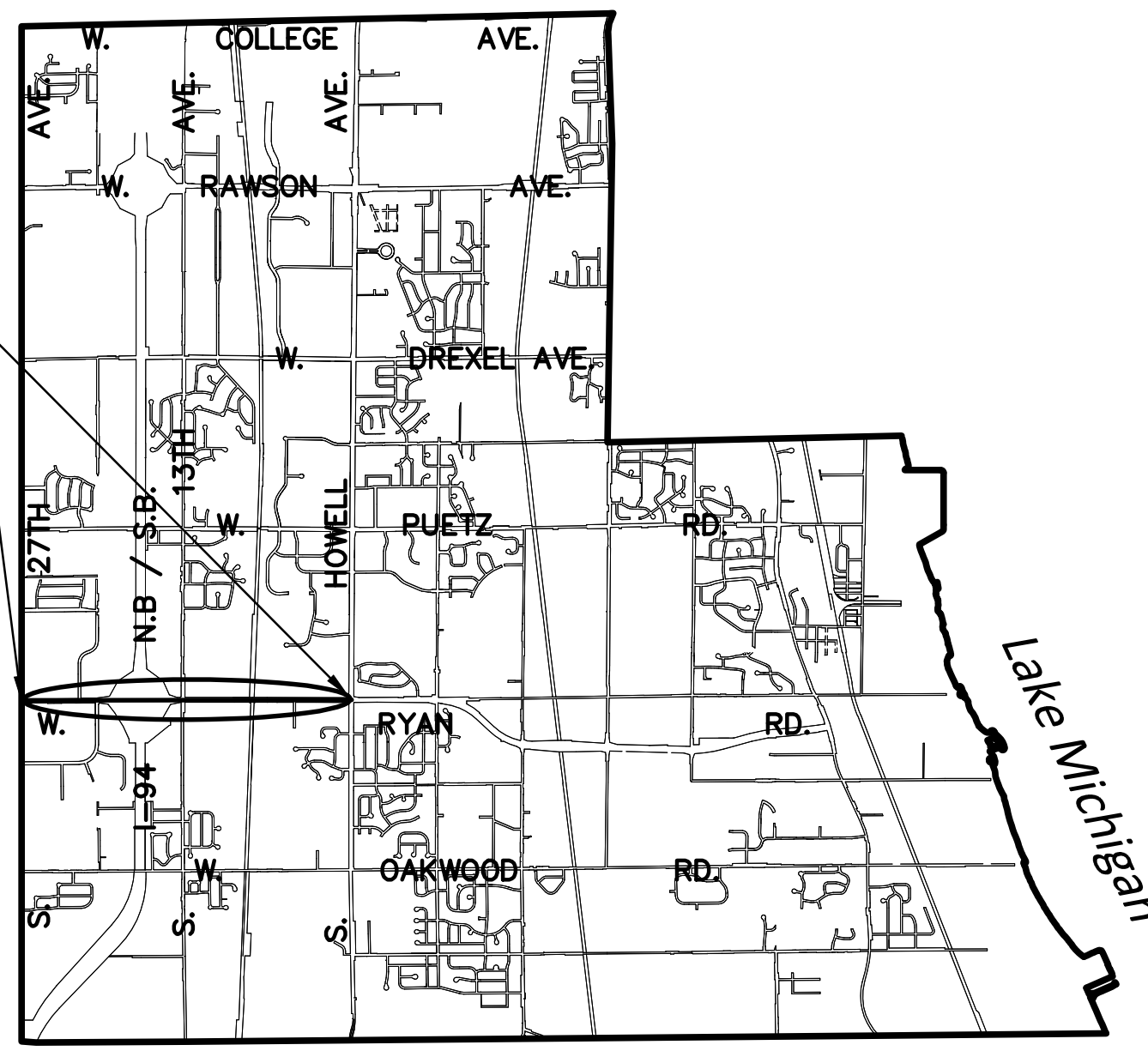

### CITY OF OAK CREEK VICINITY MAP

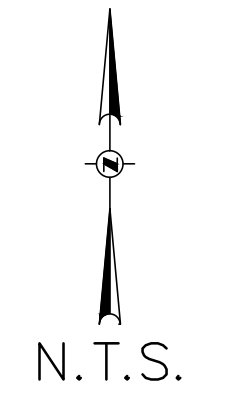

**ADDENDUM #1 JANUARY 29, 2014**

# PROJECT ENGINEER: GRAEF



**WATER and SEWER UTILITY**  
A COMMITMENT TO WATER QUALITY

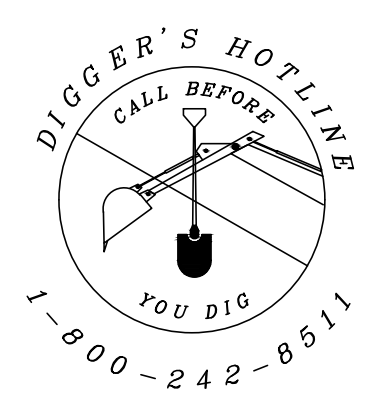
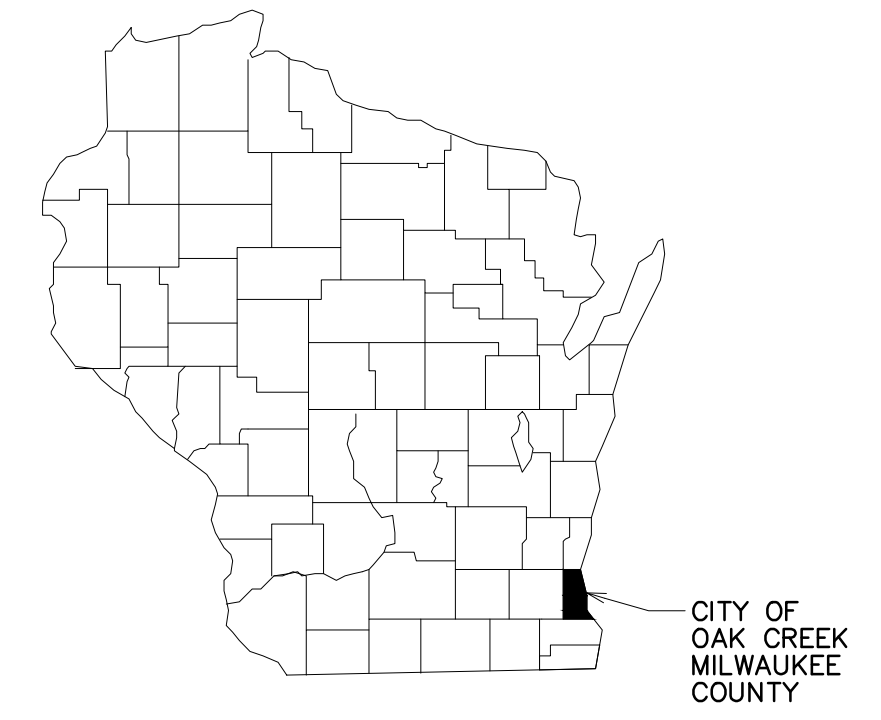

**GRAEF**  
One Honey Creek Corporate Center  
125 South 84th Street, Suite 401  
Milwaukee, WI 53214-1469  
414 / 259 1500  
414 / 259 0037 fax  
[www.graef-usa.com](http://www.graef-usa.com)

**GENERAL NOTES FOR WATER MAIN CONSTRUCTION**

- THE BASE SURVEY AND PROPOSED LINework WAS PREPARED BY OTHERS. ALL UNDERGROUND UTILITIES AND STRUCTURES HAVE BEEN SHOWN TO A REASONABLE DEGREE OF ACCURACY AND IT SHALL BE THE CONTRACTOR'S RESPONSIBILITY TO VERIFY THEIR EXACT LOCATION AND TO AVOID DAMAGE THERETO.
- CONTRACTOR SHALL VERIFY LOCATION OF PROPOSED WORK AND REPORT ANY DISCREPANCIES TO THE ENGINEER PRIOR TO COMMENCING WORK.
- CONTRACTOR SHALL FURNISH ALL PROPOSED HYDRANTS WITH A BURY DEPTH OF 6- FEET AND PROVIDE EXTENSIONS AS REQUIRED TO SET BOTTOM HYD. FLANGE AT THE PROPOSED GROUND ELEVATION.
- ALL JOINTS AND FITTINGS SHALL BE RESTRAINED WITH MEGA LUGS OR ENGINEER APPROVED EQUAL.
- CONTRACTOR SHALL VERIFY PROPOSED ROADWAY IMPROVEMENTS PRIOR TO CONSTRUCTION AND NOTIFY ENGINEER OF ANY DISCREPANCIES WITH PROPOSED PLAN.
- CONTRACTOR SHALL PROVIDE CONCRETE BUTTRESS RESTRAINT AT ALL HORIZONTAL BENDS W/STANDARD DIMENSIONS PER FILE NO. 44 OF THE STANDARD SPECIFICATIONS.
- ALL DIMENSIONS ARE TO CENTER OF STRUCTURE OR OPERATING NUT OF HYDRANT.
- RESTRAIN ALL HYDRANT LEAD JOINTS.
- LOCATE PROPOSED HYDRANT BASED ON DIMENSION FROM EXISTING CURB.
- CONTRACTOR SHALL FURNISH ALL HYDRANTS NOT SALVAGED UNDER HYDRANT RELOCATION AND ALTERATION BID ITEMS.
- CONTRACTOR SHALL INSULATE ALL HYDRANT LEADS AND MAINLINE WATER MAIN WHERE GROUND COVER IS LESS THAN 6- FEET. INSULATION IS INCIDENTAL TO WATER MAIN AND HYDRANT ALTERATION/RELOCATION BID ITEMS.
- CONTRACTOR SHALL BACKFILL ALL TRENCH EXCAVATIONS WITH GRANULAR BACKFILL AS DESIGNATED IN SECTION 209 OF THE STATE OF WISCONSIN STANDARD SPECIFICATIONS FOR HIGHWAY AND STRUCTURE CONSTRUCTION. ALL CURB AND GUTTER AND ROADWAY RESTORATION SHALL BE ASPHALT PAVEMENT.
- PHASING TABLE PROVIDES HYDRANT SETS CORRESPONDING TO A SINGLE MAIN LINE SHUT DOWN. EACH PHASE CORRESPONDS TO A SINGLE 5-HOUR SHUT-DOWN PERIOD BETWEEN THE HOURS OF 10:00 PM AND 3:00 AM FOR HYDRANT ABANDONMENT WORK. ALL WORK SHALL BE PERFORMED IN ACCORDANCE WITH THE WORK RESTRICTIONS AS SET FORTH IN THE PROJECT MANUAL. CONTRACTOR SHALL SUBMIT SCHEDULE/PHASING PLAN FOR UTILITY REVIEW/APPROVAL.
- CONTRACTOR SHALL DELIVER EXISTING HYDRANTS AND SALVAGED VALVES NOT BEING REINSTALLED TO THE OAK CREEK WATER AND SEWER BUILDING LOCATED AT 170 W. DREXEL AVE. OAK CREEK, WI 53154 AND COORDINATE DELIVERY WITH UTILITY PERSONNEL.
- COORDINATES IN THIS PLAN ARE REFERENCED TO THE WISCONSIN COUNTY COORDINATE SYSTEM (WCCS), MILWAUKEE COUNTY, (NAD 1983(97)). ELEVATIONS SHOWN ON THIS PLAN ARE REFERENCED TO THE NORTH AMERICAN VERTICAL DATUM OF 1988 (NAVD88(91)).
- CONTRACTOR SHALL INSTALL GALVANIC ANODE CORROSION PROTECTION AT EACH ABANDONED HYDRANT TEE, AND AT EACH CONNECTION TO EXISTING WATER MAIN.
- CONTRACTOR SHALL RESTRAIN ALL UN-RESTRAINED EXISTING HYDRANT AUXILIARY VALVES TO EXISTING ANCHOR TEES EXPOSED DURING HYDRANT ALTERATION/RELOCATION BID ITEMS.
- PROPOSED HYDRANT LEAD LENGTHS ON DRAWINGS ARE APPROXIMATE ONLY. ADDITIONAL HYDRANT LEAD LENGTH REQUIRED TO MEET PROPOSED HYDRANT LOCATIONS IS INCIDENTAL TO HYDRANT UNIT BID ITEM.

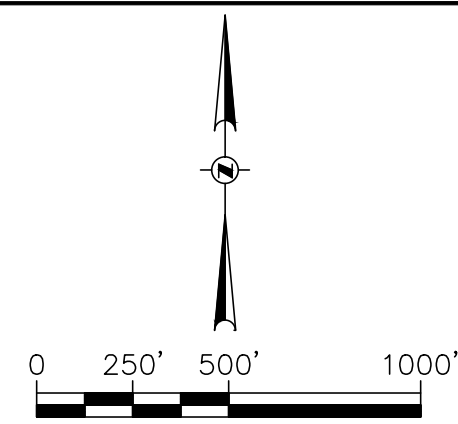

**EROSION CONTROL NOTES**

- CONSTRUCTION SITE AND SEDIMENTATION CONTROL SHALL COMPLY WITH THE REQUIREMENTS OF THE CITY OF OAK CREEK, AND SHALL EMPLOY EROSION CONTROL METHODS AS SHOWN AND SPECIFIED IN THE WISCONSIN DEPARTMENT OF NATURAL RESOURCES CONSTRUCTION SITE EROSION AND SEDIMENTATION CONTROL TECHNICAL STANDARDS.
- ALL EROSION CONTROL MEASURES SHALL BE ADJUSTED TO MEET FIELD CONDITIONS AT THE TIME OF CONSTRUCTION AND SHALL BE INSTALLED PRIOR TO ANY GRADING OR DISTURBANCE OF EXISTING SURFACE MATERIAL ON THE SITE.
- PERIODIC INSPECTION AND MAINTENANCE OF ALL EROSION CONTROL STRUCTURES SHALL BE PROVIDED TO ENSURE INTENDED PURPOSE IS ACCOMPLISHED. CONTRACTOR SHALL BE RESPONSIBLE FOR CLEANUP AND REMOVAL OF ALL SEDIMENT LEAVING THE PROJECT LIMITS. EROSION CONTROL MEASURES SHALL BE IN WORKING CONDITION AT THE END OF EACH WORK DAY.
- SILT FENCE SHALL BE INSTALLED AS DIRECTED BY THE FIELD ENGINEER.
- INLET PROTECTION SHALL BE INSTALLED ON ALL INLETS RECEIVING RUNOFF FROM THE PROJECT AREA TO TRAP SEDIMENT.
- EROSION CONTROL MEASURES SHALL BE MAINTAINED ON A CONTINUING BASIS UNTIL SITE IS FULLY STABILIZED.
- ALL DISTURBED AREAS WILL BE PERMANENTLY STABILIZED BY THE APPLICATION OF SEED AND MULCH. THE TYPE OF SEED USED WILL BE WISDOT MIXTURE 40 AS SPECIFIED IN THE LATEST EDITION OF THE STATE OF WISCONSIN STANDARDS SPECIFICATIONS FOR HIGHWAY AND STRUCTURE CONSTRUCTION.
- TYPE "C" EROSION CONTROL MATTING SHALL BE USED ON ALL SLOPES 3:1 OR GREATER AND AS DIRECTED BY FIELD ENGINEER.

**TRAFFIC CONTROL NOTES**

- TRAFFIC CONTROL SHALL BE INSTALLED IN STAGES CORRESPONDING TO WORK ZONES, AND SHALL BE LIMITED TO AREAS WHERE WORK IS ACTIVELY TAKING PLACE TO MINIMIZE DISRUPTION TO MOTORISTS.
- ALL TRAFFIC CONTROL SIGNAGE SHALL HAVE DIAMOND GRADE SHEETING PER WISDOT STANDARDS.
- CONTRACTOR SHALL MAINTAIN A MINIMUM OF TWO LANES OF TRAFFIC ON EASTBOUND RYAN ROAD BETWEEN THE HOURS OF 3:00PM AND 7:00 PM, AND PROVIDE TEMPORARY ASPHALT PAVEMENT AS NEEDED TO MAINTAIN TRAFFIC. (INCIDENTAL TO WATER MAIN BID ITEM)

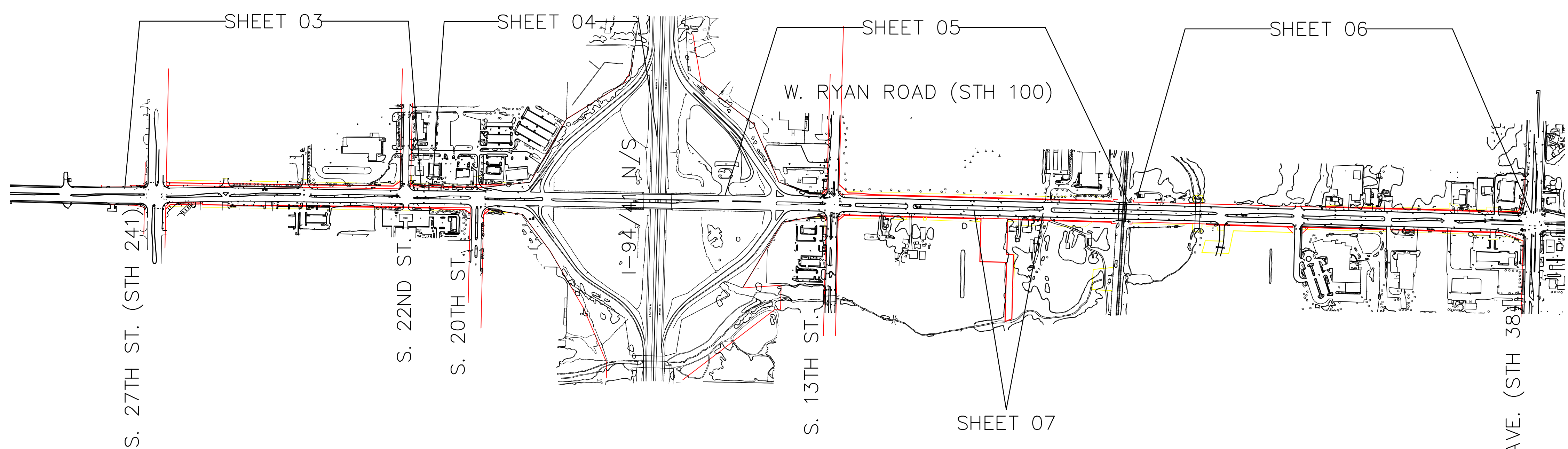

WATER MAIN SHUT DOWN SCHEDULE		
HYDRANT IDS	DETAIL	WORK TIME
90309, 87802, 87803, 87804	B, C, E, G	NIGHT
90310, 90311	D, F	DAY OR NIGHT
87805, 87806	I, K	NIGHT
90312, 90313, 90314	H, J, L	NIGHT
90504, 90503	N, O	DAY OR NIGHT
90602, 90625, 87503	Q, R, S	NIGHT
87502	U	DAY OR NIGHT
90309	A	DAY OR NIGHT
87701	M	DAY OR NIGHT
90501	P	DAY OR NIGHT
90606	T	DAY OR NIGHT
87501	V	NIGHT
90404	W	DAY OR NIGHT

\*SEE GENERAL NOTE 13.

**NOTICE:**  
In accordance with Wisconsin statute 182.0175, damage to transmission facilities, excavator shall be solely responsible to provide advance notice to the designated "ONE CALL SYSTEM" not less than three working days prior to commencement of any excavation required to perform work contained on this drawing, and further, excavator shall comply with all other requirements of this statute relative to excavator's work.

**DISCLAIMER:**  
The underground utilities shown have been located from field survey information and existing drawings. The surveyor makes no guarantee that the underground utilities shown comprise all such utilities in the area, either in service or abandoned. The surveyor further does not warrant that the underground utilities shown are in the exact location indicated although he does certify that they are located as accurately as possible from information available. The surveyor has not physically located the underground utilities.

**GRAEF**  
One Honey Creek Corporate Center  
125 South 84th Street, Suite 401  
Milwaukee, WI 53214-1469  
414 / 259 1500  
414 / 259 0037 fax  
www.graef-usa.com

BID ITEM NOS.	ESTIMATE OF QUANTITIES	WATER MAIN CONTRACTOR:	SA.FKO	CITY OF OAK CREEK, WISCONSIN			APPROVED BY				
		MAINLINE INSPECTED BY:	ST.FKO	DESIGNED BY	DATE	DRAWN BY	DATE	CHECKED BY	DATE	UTILITY ENGINEER	DATE
		LATERALS INSPECTED BY:	W. FKO	AS	2-13-14	FKO	2-13-14	MNP	2-13-14	APPROVED BY	
		DATE COMPLETED:	G. FKO								
		TYPE OF PIPE, ASTM NO.	E. FKO								
		TYPE OF PIPE, ASTM NO.	T. FKO								
		AS-BUILTS BY:	I. FKO								
		DATE:	TS.FKO								
		This is to certify that this plan was approved by the Water Works and Sewer Utility Commission of Oak Creek at a regular meeting.	PP.								
		Utility Engineer		ADD 1	01/29/14						
		Date		REVISION BY	DATE						
				S. HOWELL AVE (STH 38) HYDRANT RELOCATIONS IN: W. RYAN ROAD (STH 100) FR: S. 27TH ST. TO: S. HOWELL. AVE.							
				SCALE SHEET PLAN HOR. AS NOTED 02 OF 13							
				FILE NO: 14104-2C-2197							

L:\basin\1301\0336\06\CAD\Sheet\06\WOOD1\_RyanC\_06\_RyanHD\_Cover\_360.dwg, 1/29/2014 2:24:02 PM, 1530, DWG To PDF.pc3

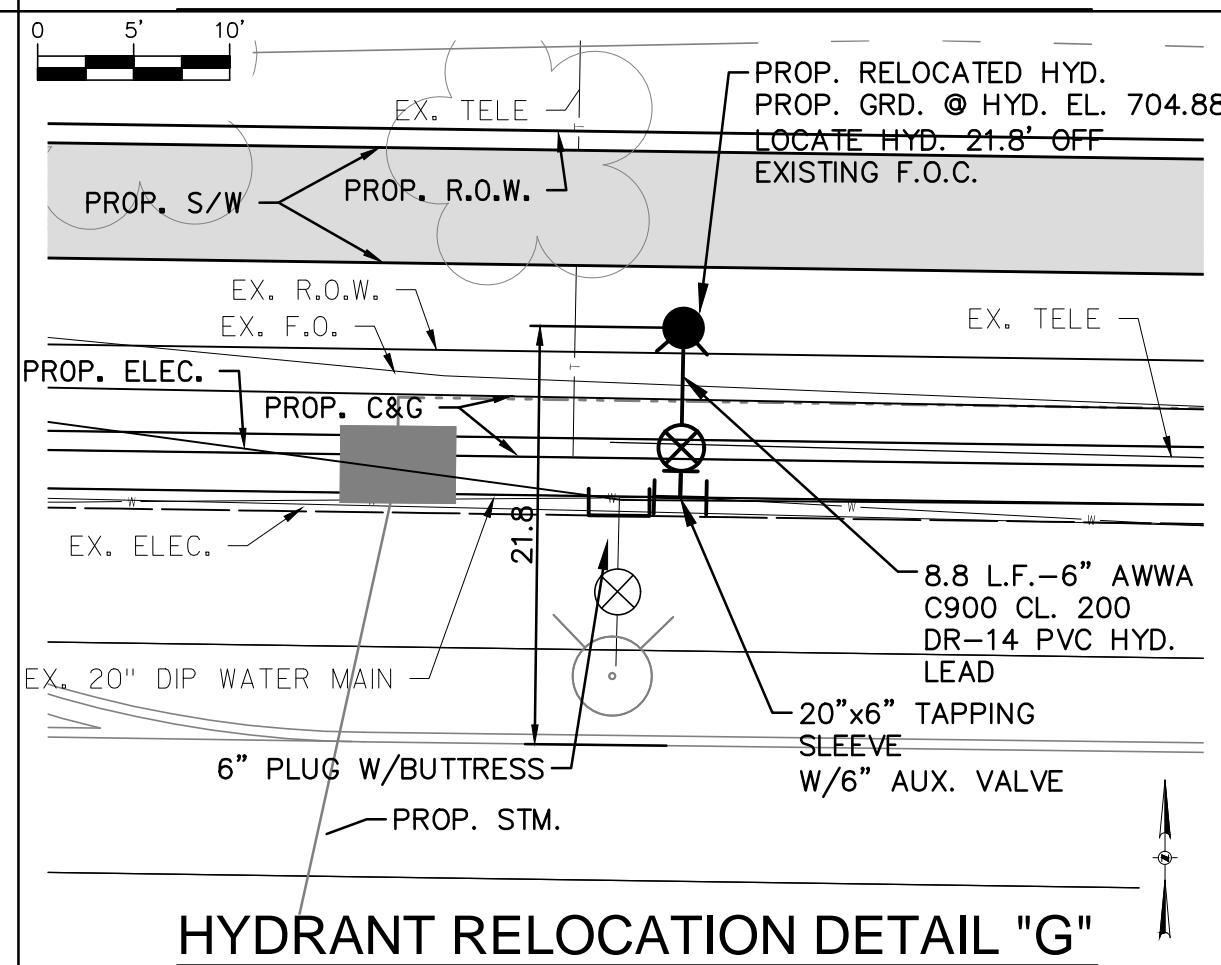
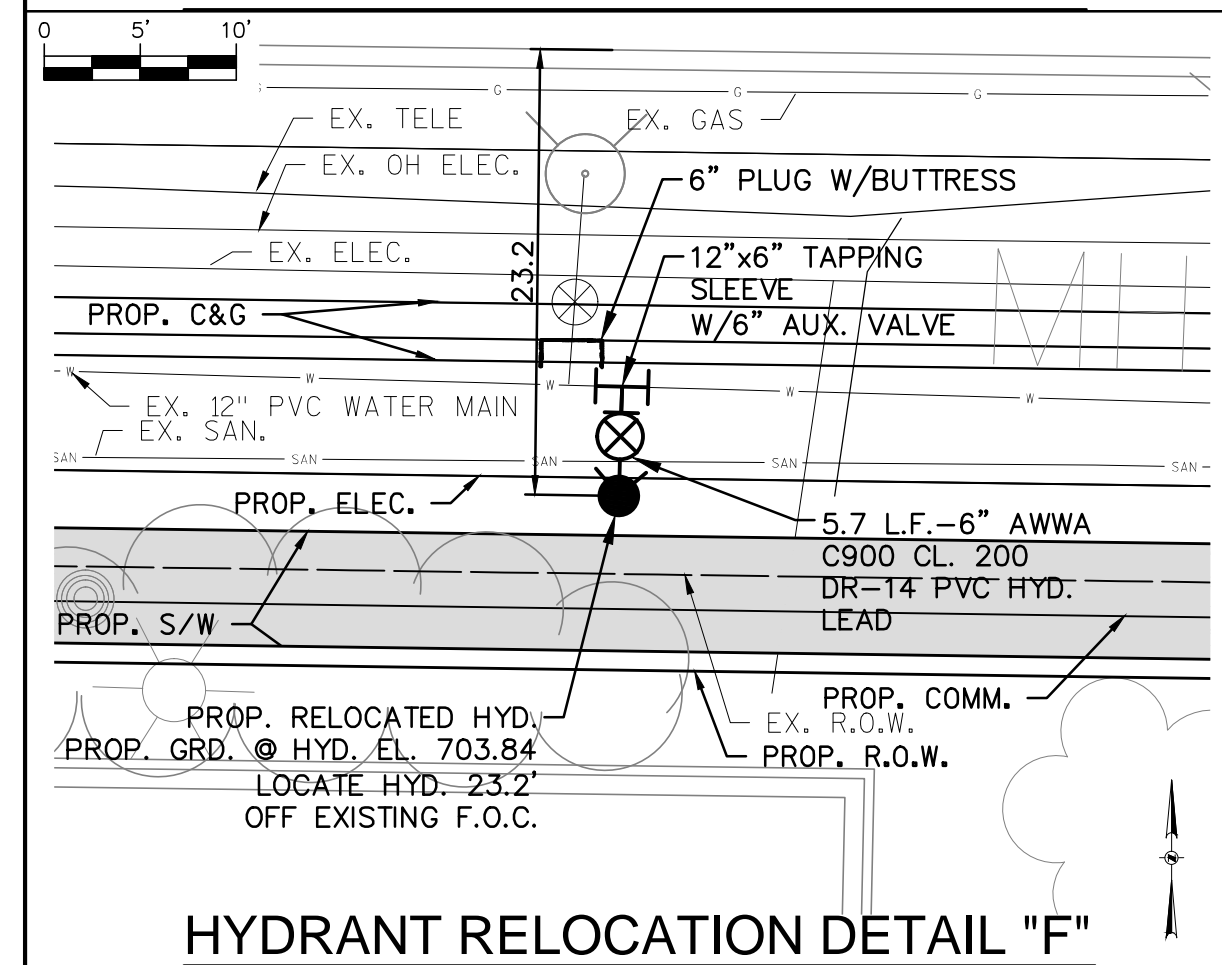
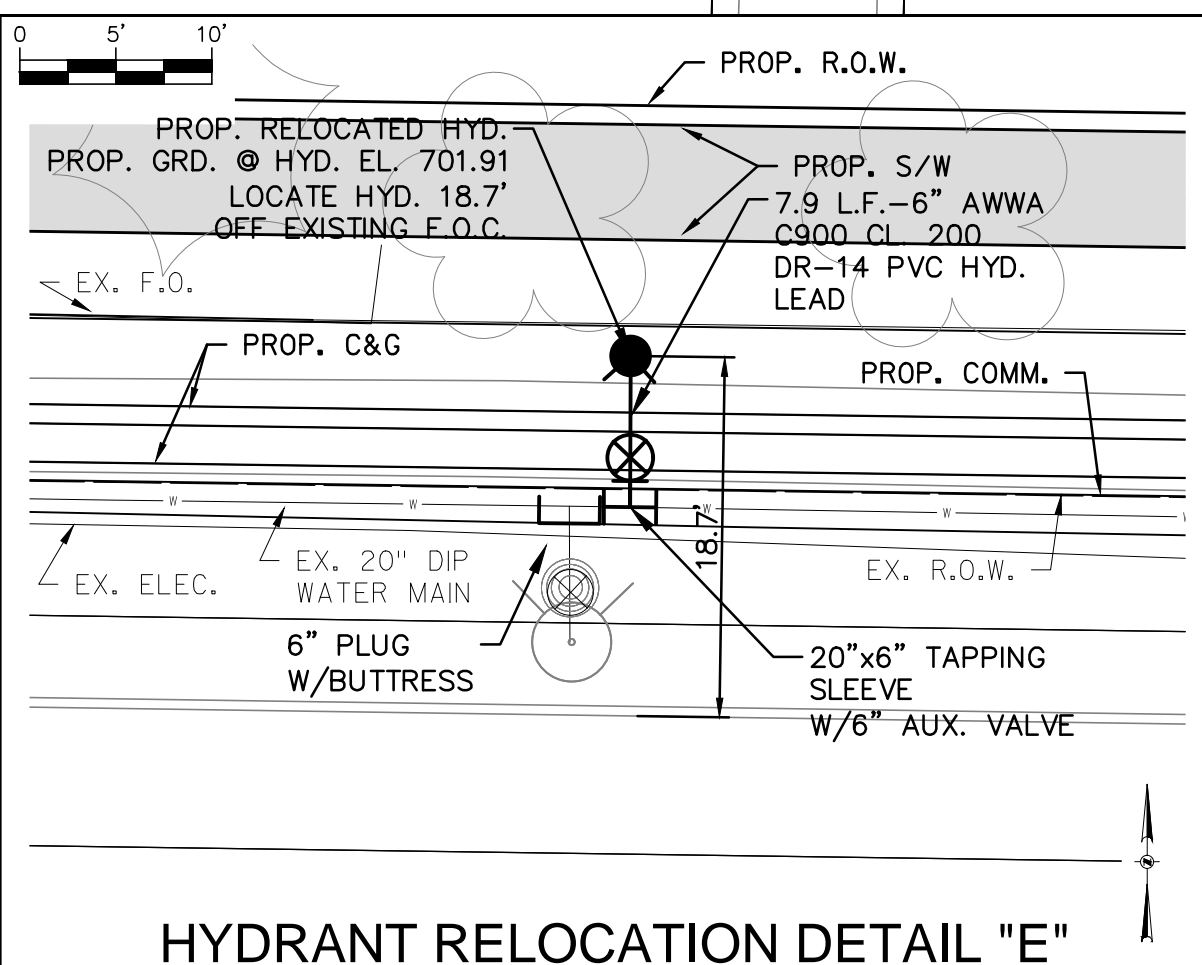
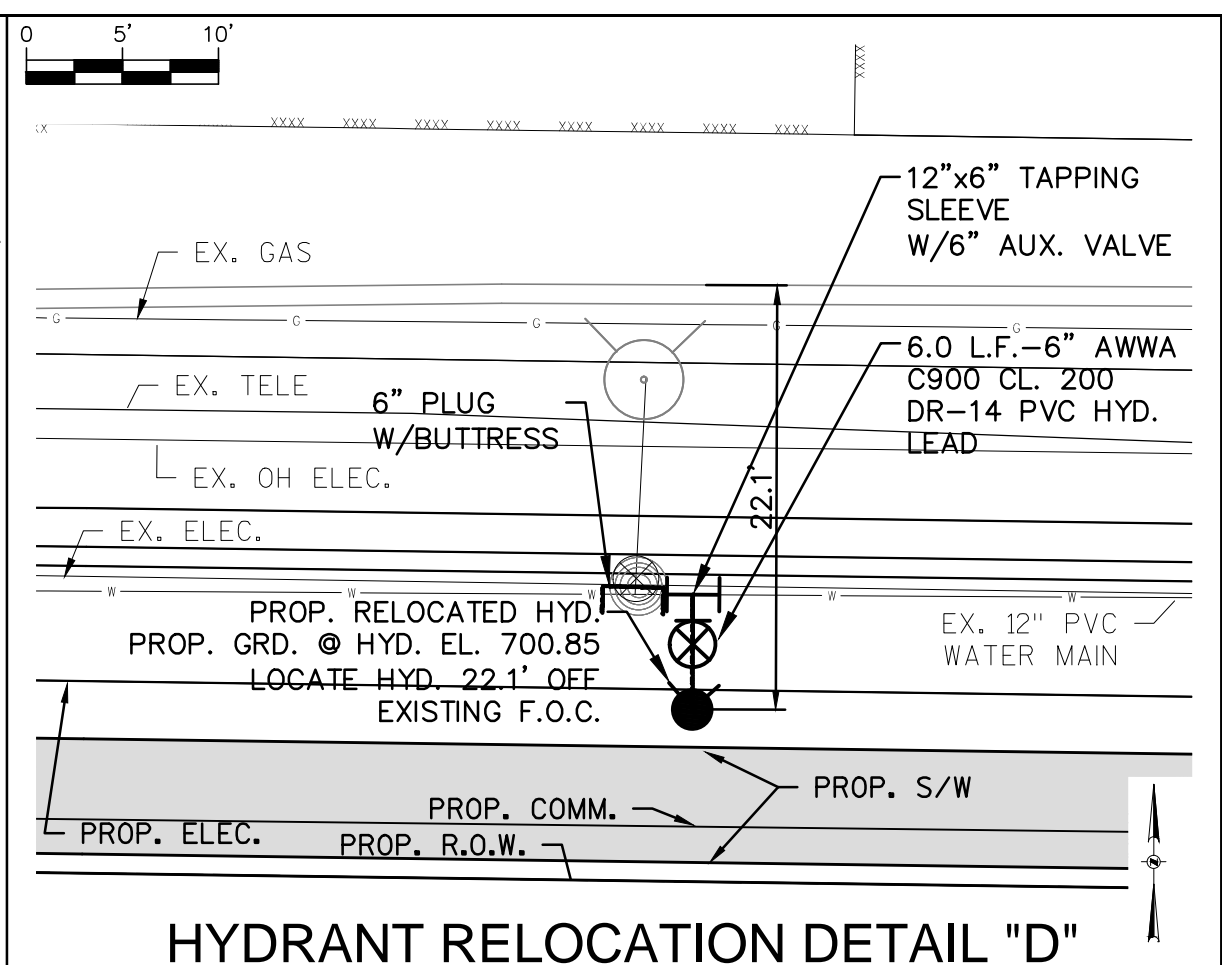
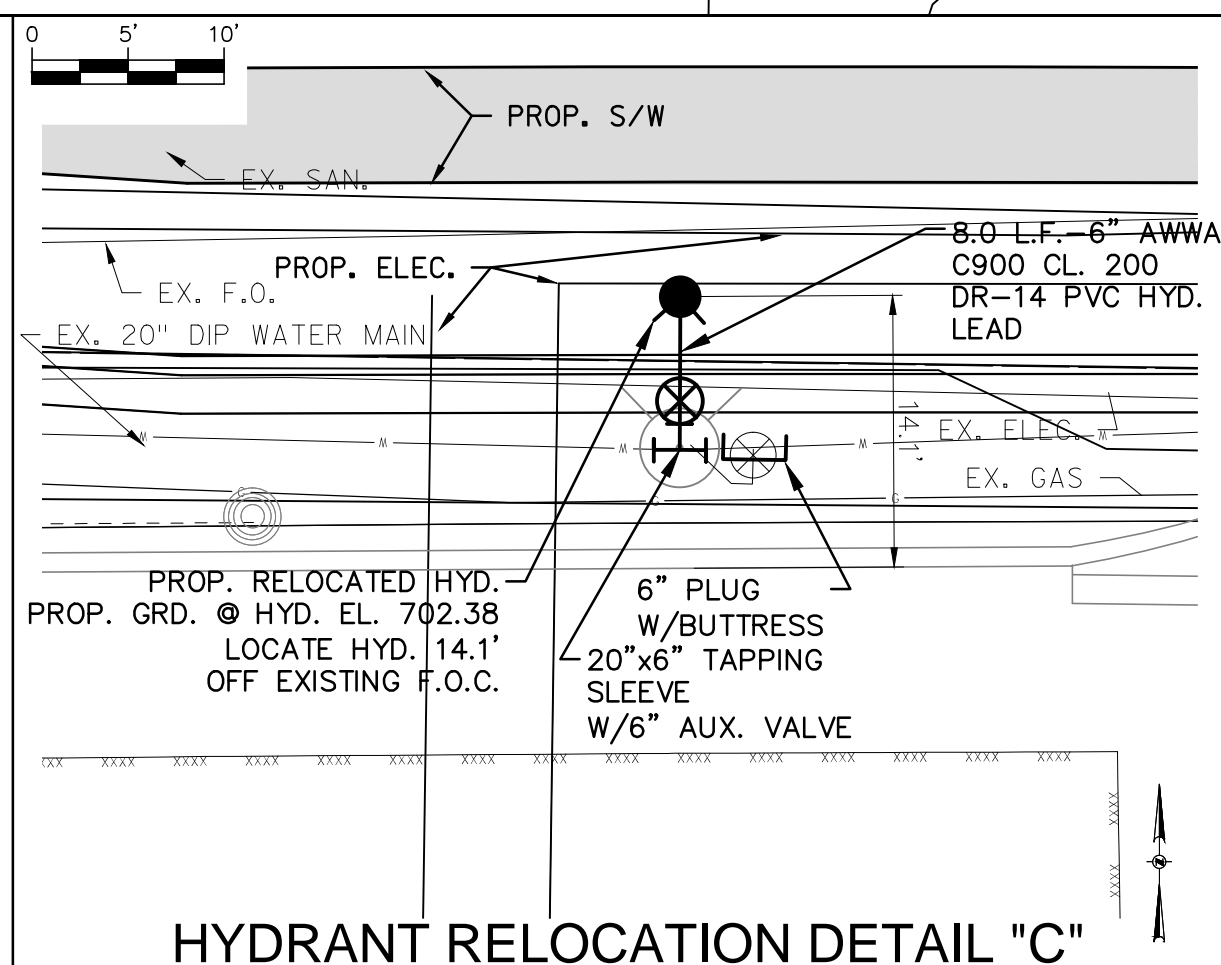
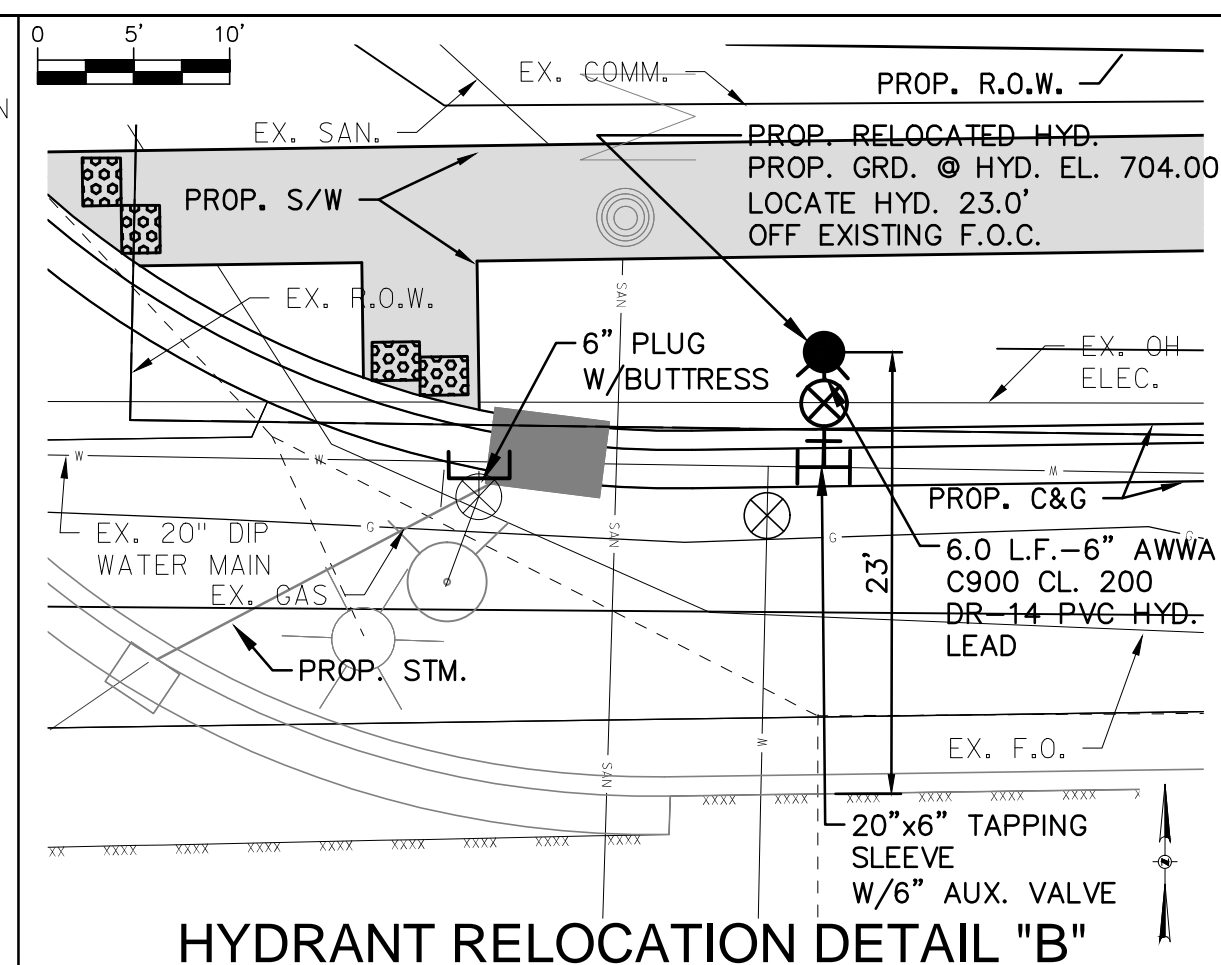
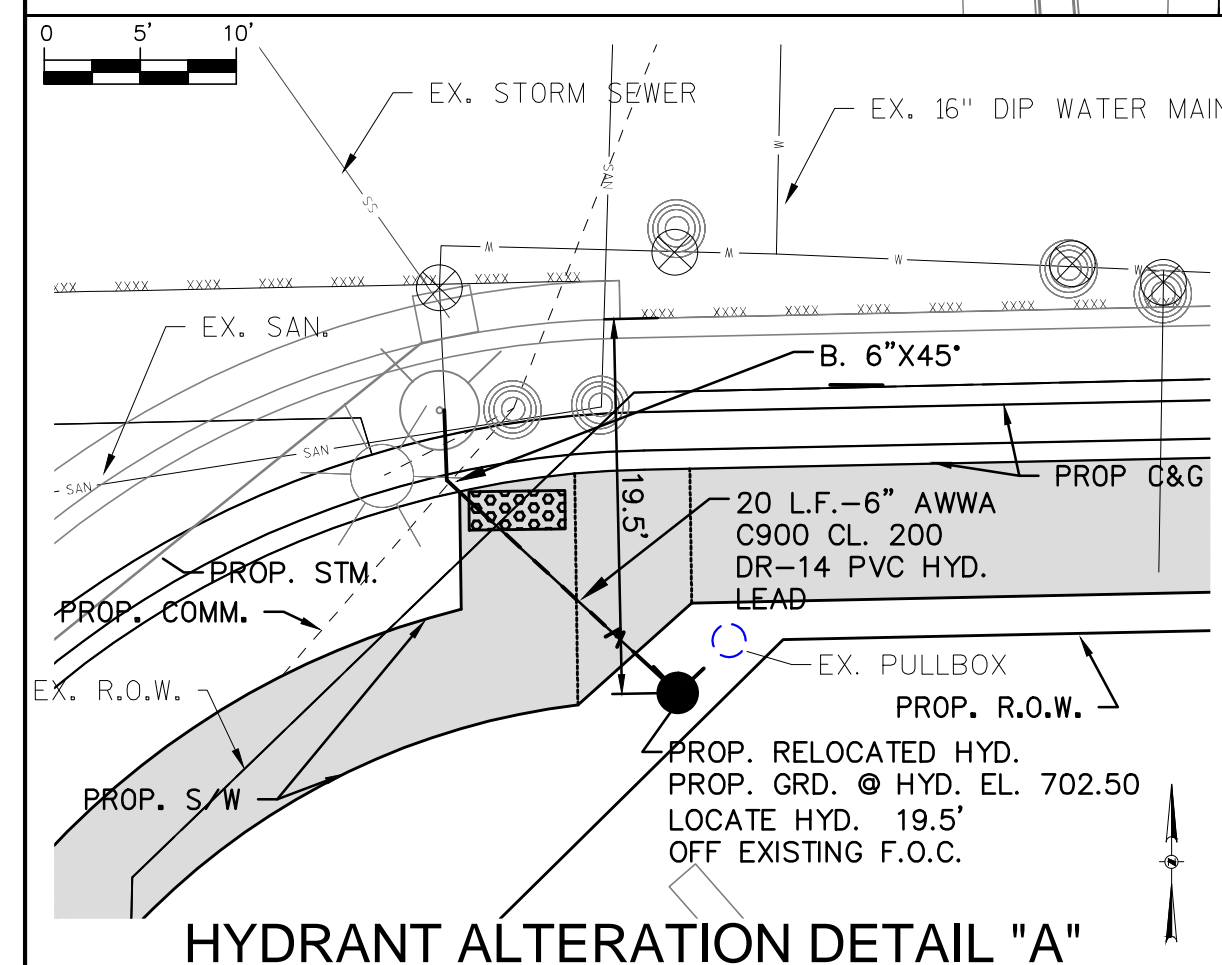
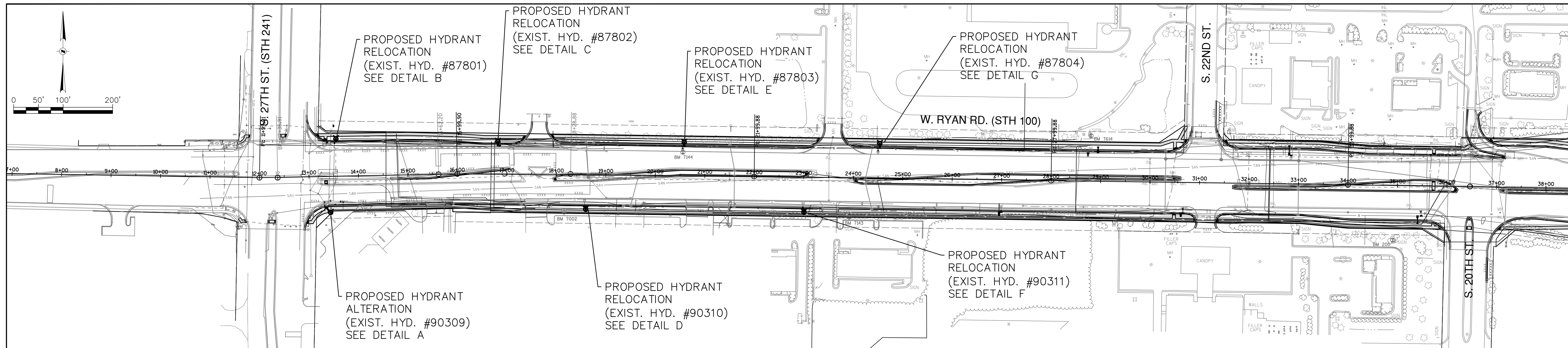

**LEGEND**

- X - STRUCTURE REMOVAL
- - - - - PROPOSED WATER MAIN
- - PROPOSED HYDRANT
- - PROPOSED PLUG
- ⊗ - PROPOSED GATE VALVE
- - EXISTING HYDRANT
- ⊗ - EXISTING GATE VALVE

**GRÄEF**  
 One Honey Creek Corporate Center  
 125 South 84th Street, Suite 401  
 Milwaukee, WI 53214-1469  
 414 / 259 1500  
 414 / 259 0037 fax  
 www.graef-usa.com

NOTICE: In accordance with Wisconsin statute 182.0175, damage to transmission facilities, excavator shall be solely responsible to provide advance notice to the designated "ONE CALL SYSTEM" not less than three working days prior to commencement of any excavation required to perform work contained on this drawing, and further, excavator shall comply with all other requirements of this statute relative to excavator's work.

DISCLAIMER: The underground utilities shown have been located from field survey information and existing drawings. The surveyor makes no guarantee that the underground utilities shown comprise all such utilities in the area, either in service or abandoned. The surveyor further does not warrant that the underground utilities shown are in the exact location indicated although he does certify that they are located as accurately as possible from information available. The surveyor has not physically located the underground utilities.

ESTIMATE OF QUANTITIES	
BID ITEM NOS.	DESCRIPTION
1	Hydrant Relocation, including removing existing hydrants, valves, and pipe as needed, furnishing and installing new 6.0 foot hydrants, 6" C900 CL 200 DR-14 restrained water main pipe, 6" gate valve fittings, tapping sleeves, live tap to existing water main, buttresses, excavation, insulation, granular backfill and asphalt restoration as designated on the Drawings
2	Hydrant alteration, including removing existing hydrants, valves, and pipe as needed, furnishing and installing new 6.0 foot hydrants, 6" C900 CL 200 DR-14 PVC restrained water main pipe fittings, provide and install anode protection, temporary plugs, caps, buttresses, flushing vents for testing and sampling, excavation, insulation, granular backfill and asphalt restoration as designated on the Drawings.

WATER MAIN	
CONTRACTOR:	
SA.FKO	ST.FKO
W. FKO	G. FKO
E. FKO	T. FKO
I. FKO	TS.FKO
PP.	
ADD 1	01/29/14
REVISION BY	DATE

CITY OF OAK CREEK, WISCONSIN				APPROVED BY	
DESIGNED BY	DATE	DRAWN BY	DATE	UTILITY ENGINEER	DATE
AS	1-16-14	FKO	1-16-14	MNP	1-16-14
RYAN RD. RELAY AND HYDRANT RELOCATIONS					
IN: W. RYAN ROAD (STH 100)					
FR: S. 27TH ST.					
TO: 600 FT. WEST OF S. 22ND ST.					
				CITY ENGINEER	DATE
				SCALE	SHEET
				KEY PLAN	03
				DETAIL PLAN	OF
				HOR. 1"=10'	13
FILE NO: 14104-3C-2198					

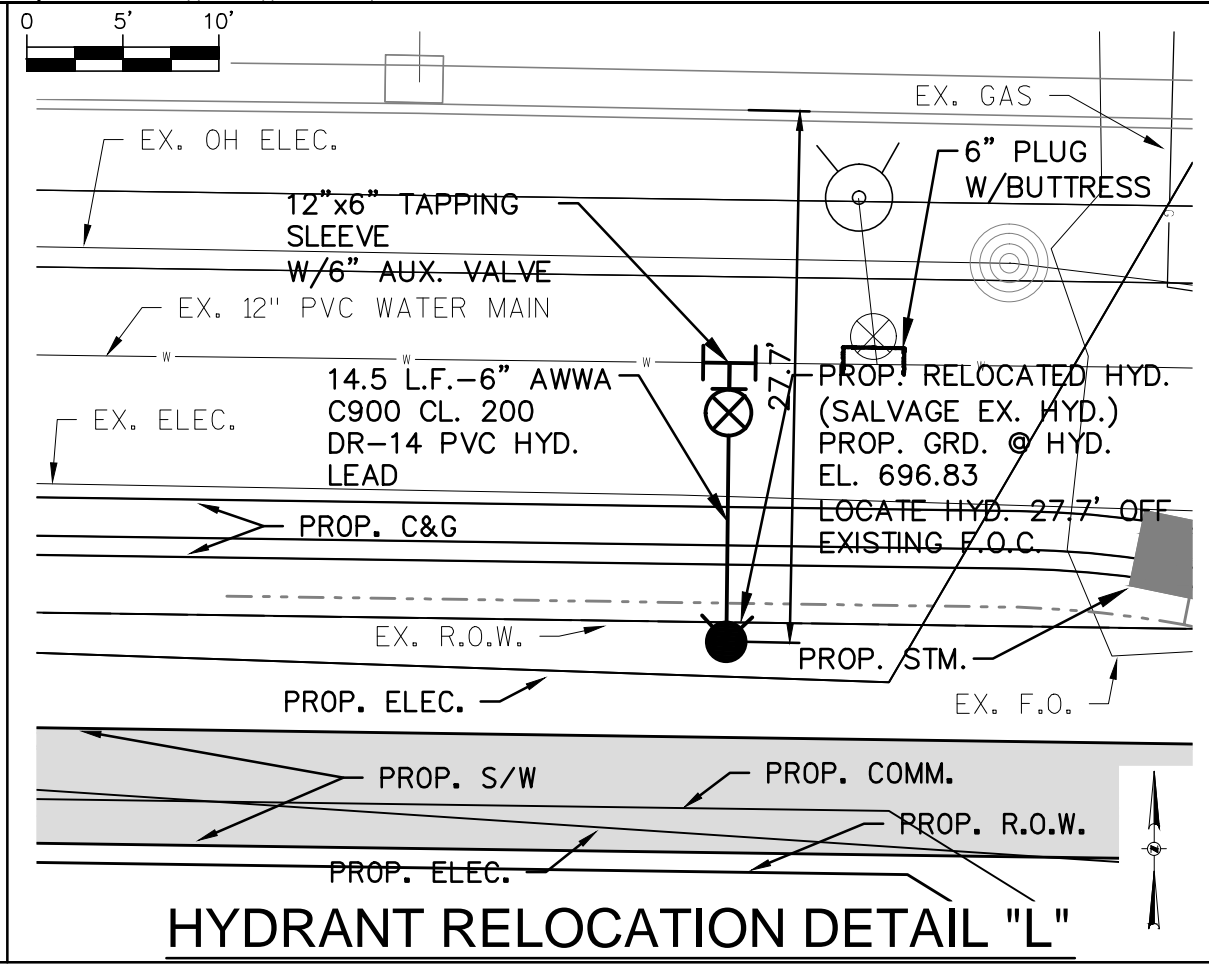
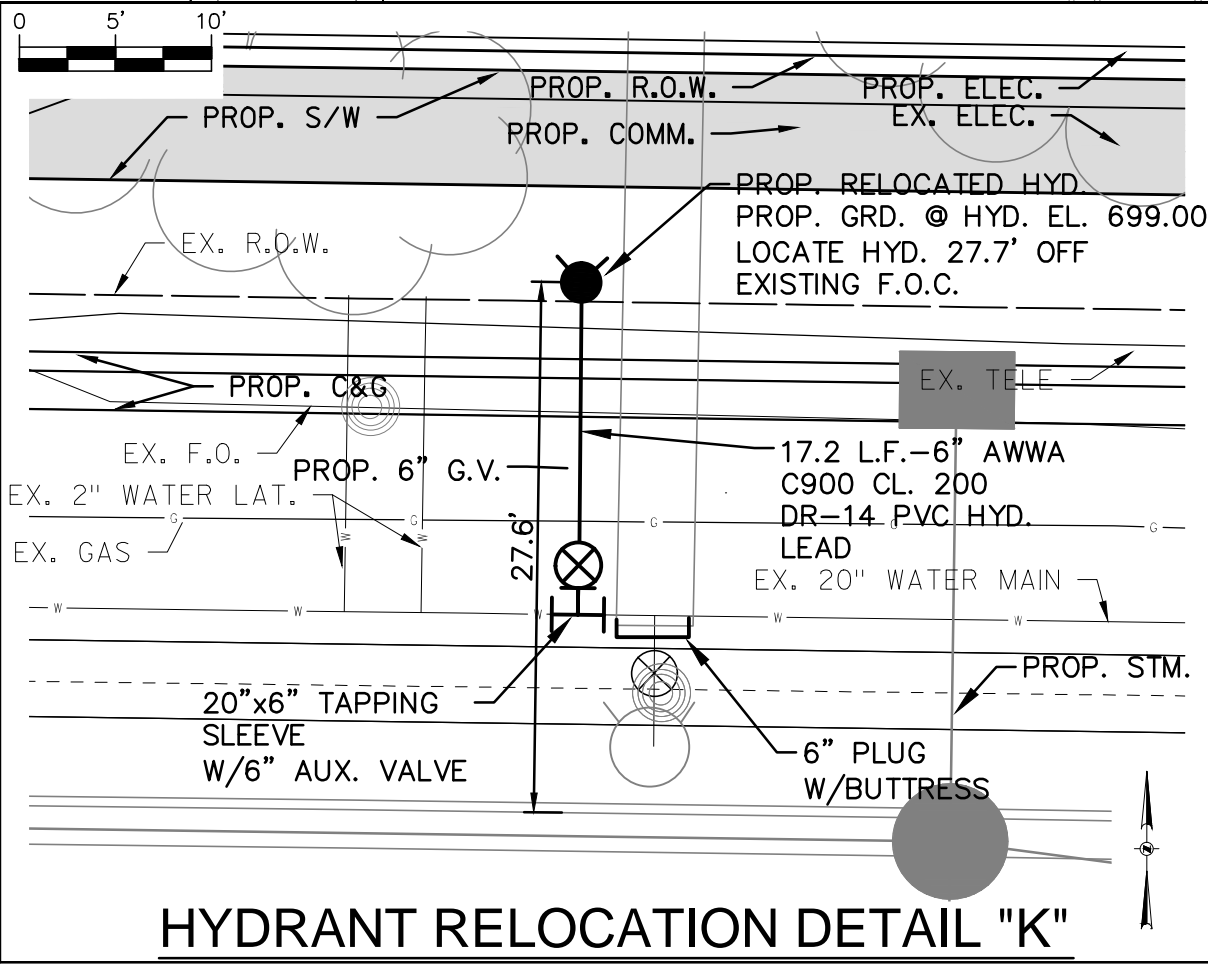
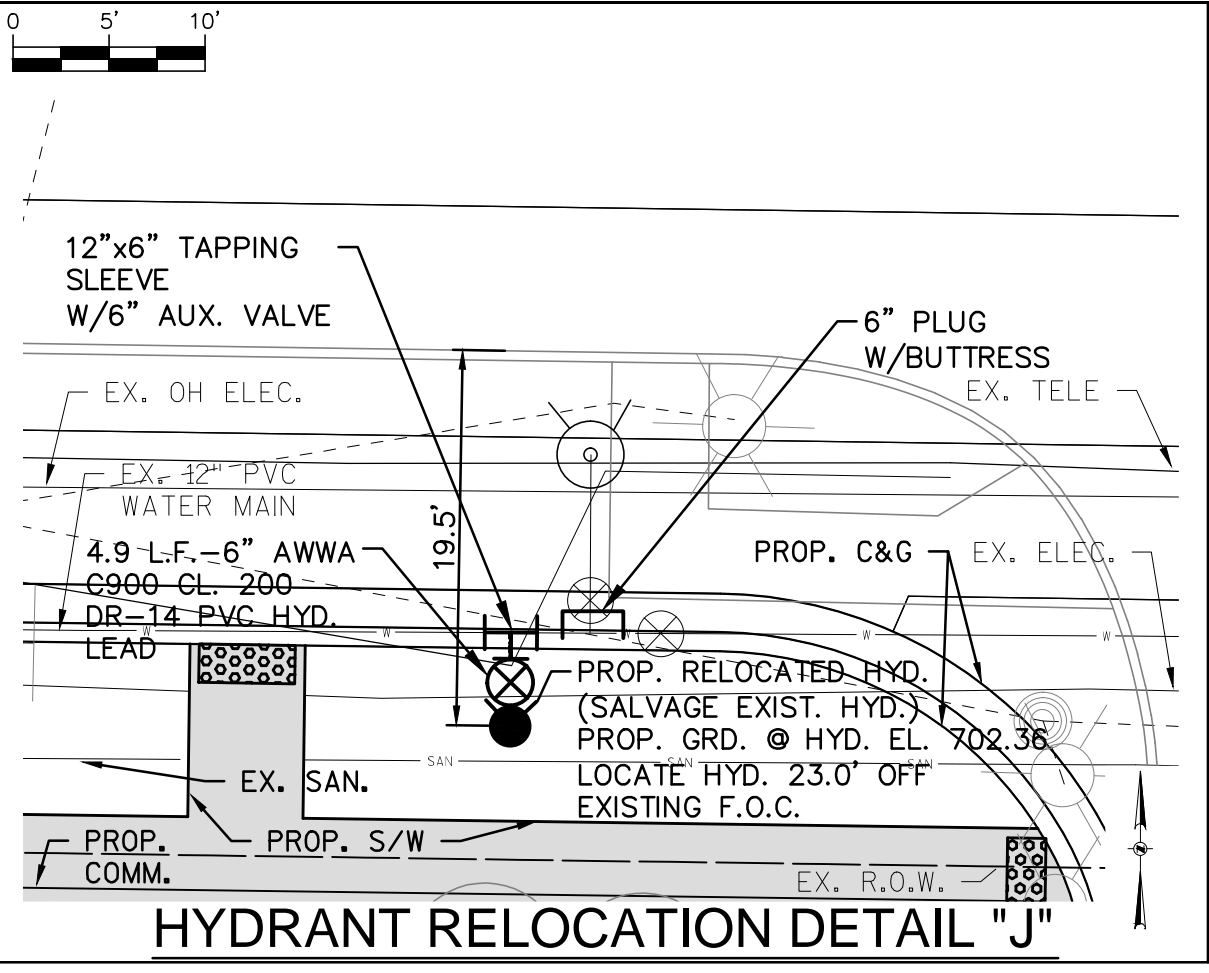
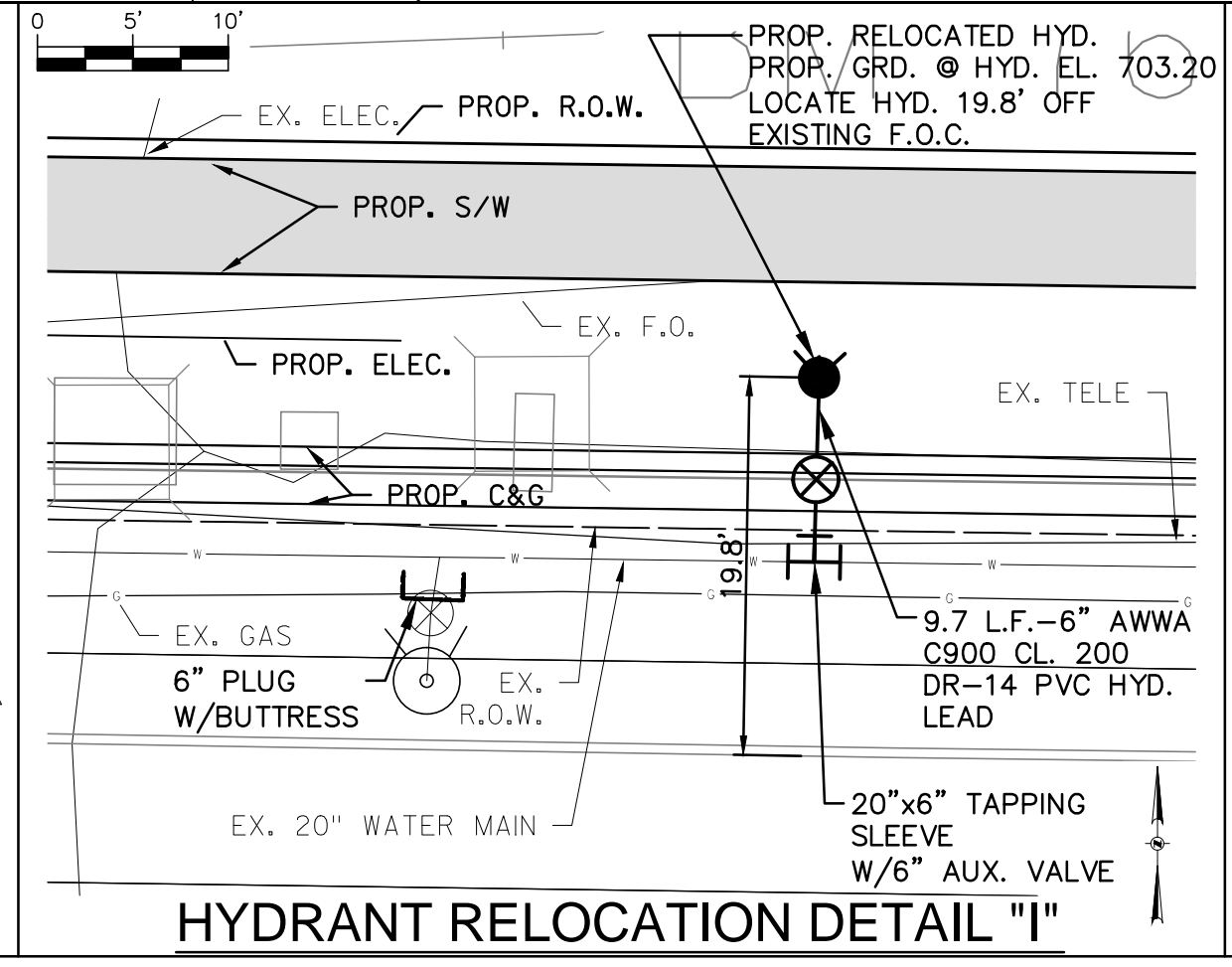
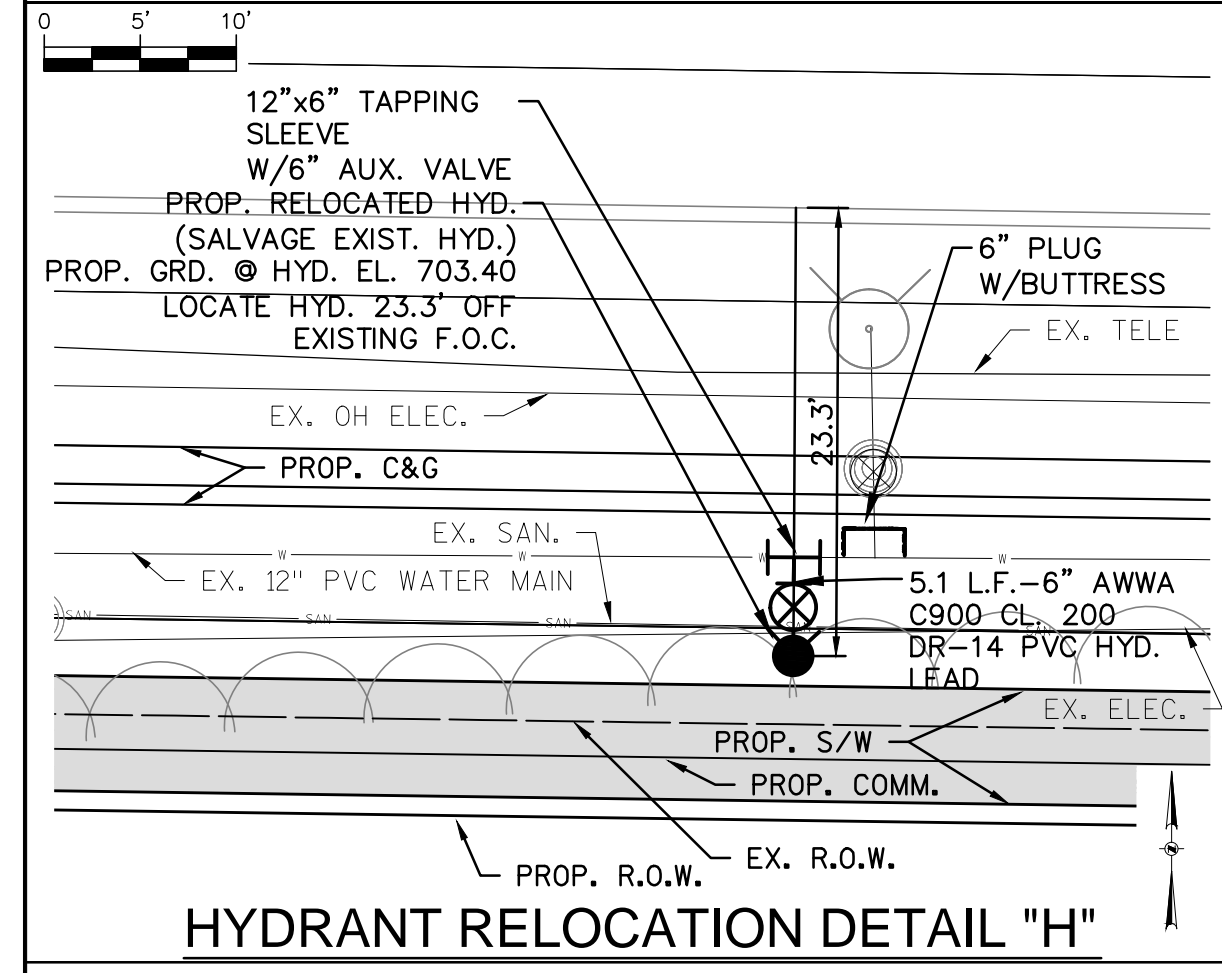
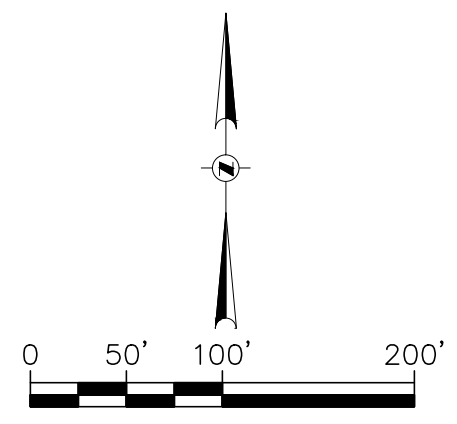
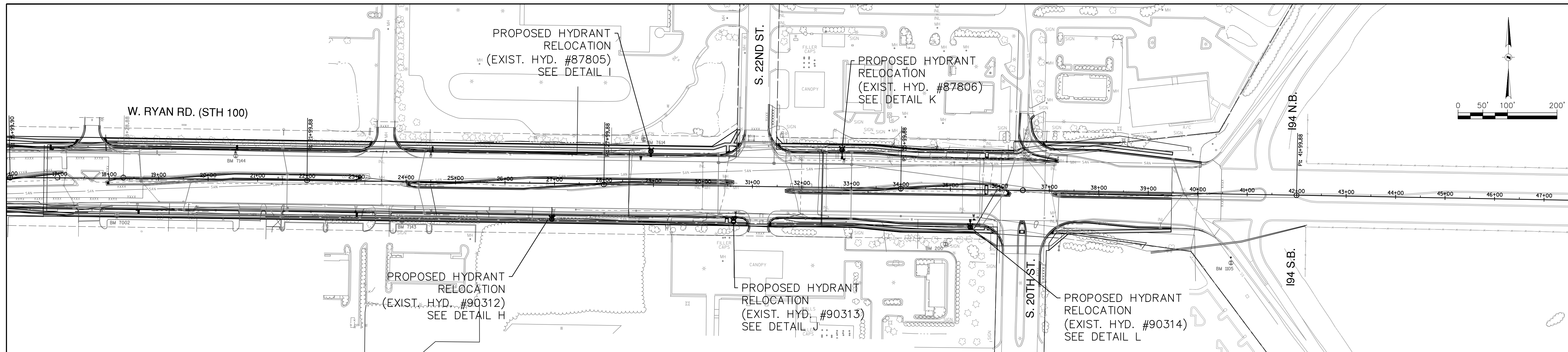

**LEGEND**

- X - STRUCTURE REMOVAL
- v- - PROPOSED WATER MAIN
- - PROPOSED HYDRANT
- - PROPOSED PLUG
- ⊗ - PROPOSED GATE VALVE
- - EXISTING HYDRANT
- ⊗ - EXISTING GATE VALVE

**NOTICE:**  
In accordance with Wisconsin statute 182.0175, damage to transmission facilities, excavator shall be solely responsible to provide advance notice to the designated "ONE CALL SYSTEM" not less than three working days prior to commencement of any excavation required to perform work contained on this drawing, and further, excavator shall comply with all other requirements of this statute relative to excavator's work.

**DISCLAIMER:**  
The underground utilities shown have been located from field survey information and existing drawings. The surveyor makes no guarantees that the underground utilities shown comprise all such utilities in the area, either in service or abandoned. The surveyor further does not warrant that the underground utilities shown are in the exact location indicated although he does certify that they are located as accurately as possible from information available. The surveyor has not physically located the underground utilities.

**GRAEF**  
One Honey Creek Corporate Center  
125 South 84th Street, Suite 401  
Milwaukee, WI 53214-1469  
414 / 259 1500  
414 / 259 0037 fax  
www.graef-usa.com

BID ITEM NOS.	ESTIMATE OF QUANTITIES	WATER MAIN	SA.FKO
1	Hydrant Relocation, including removing existing hydrants, valves, and pipe as needed, furnishing and installing new 6.0 foot hydrants, 6" C900 CL 200 DR-14 restrained water main pipe, 6" gate valve fittings, tapping sleeves, live tap to existing water main, buttresses, excavation, insulation, granular backfill and asphalt restoration as designated on the Drawings	CONTRACTOR: MAINLINE INSPECTED BY: LATERALS INSPECTED BY: DATE COMPLETED: TYPE OF PIPE, ASTM NO. TYPE OF PIPE, ASTM NO. AS-BUILTS BY: DATE: This is to certify that this plan was approved by the Water Works and Sewer Utility Commission of Oak Creek at a regular meeting. Utility Engineer Date	ST.FKO W. FKO G. FKO E. FKO T. FKO I. FKO TS.FKO PP.

CITY OF OAK CREEK, WISCONSIN	APPROVED BY
DESIGNED BY: AS DATE: 1-16-14 DRAWN BY: FKO DATE: 1-16-14 CHECKED BY: MNP DATE: 1-16-14	UTILITY ENGINEER DATE APPROVED BY
RYAN RD. RELAY AND HYDRANT RELOCATIONS IN: W. RYAN ROAD (STH 100) FR: 600 FT. WEST OF S. 22ND ST. TO: I-94 S.B. / I-94 N.B.	CITY ENGINEER DATE SCALE SHEET KEY PLAN HOR. 1"=100' 04 DETAIL PLAN HOR. 1"=10' OF 13
ADD 1 01/29/14 REVISION BY DATE	FILE NO: 14104-4C-2199

L:\basin\13101\0356\05\CAD\Sheet\00\WOODOT\_RyanC\_00\_01\_Ryan\_06.dwg 1/29/2014 2:05:35 PM 1500 DWG To PDF.plt

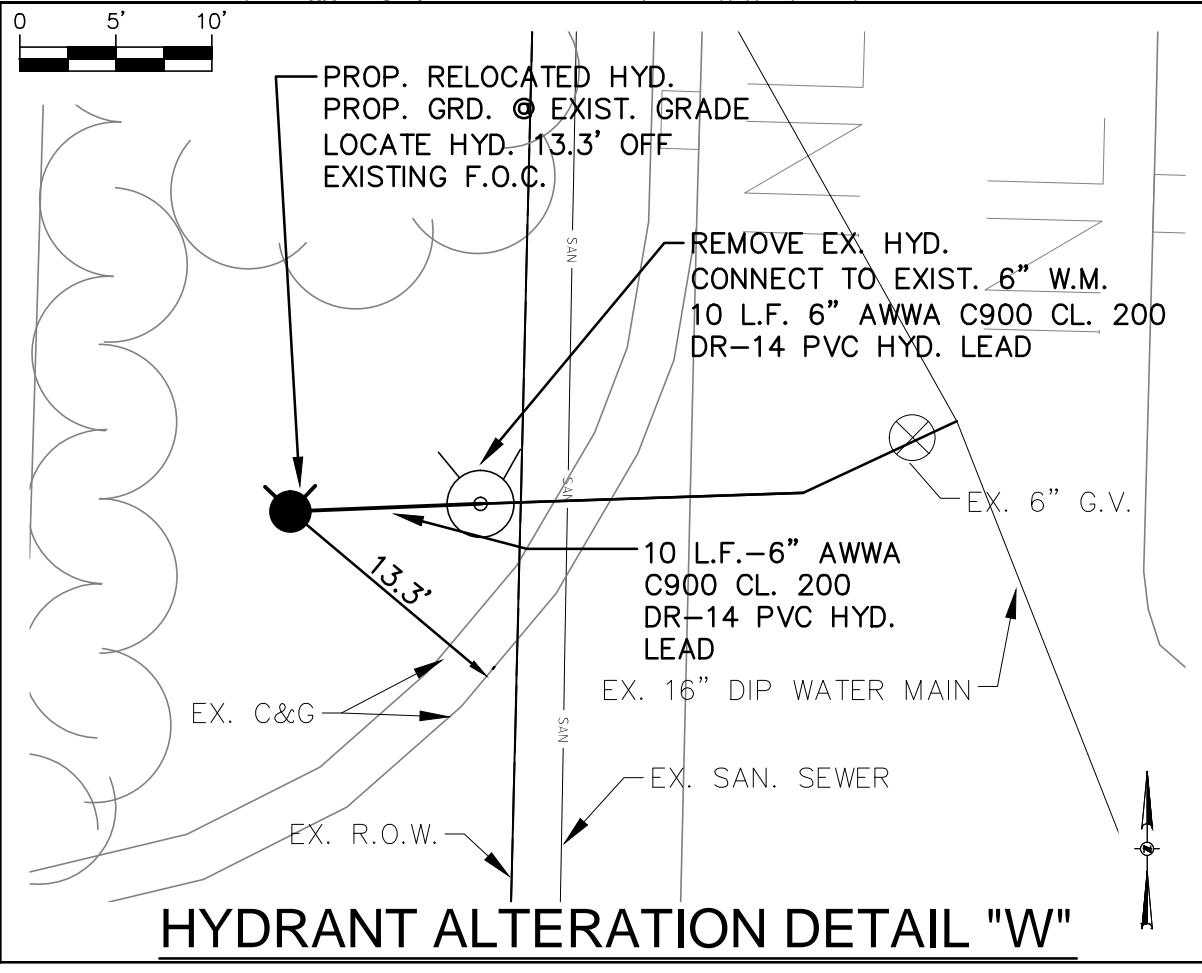
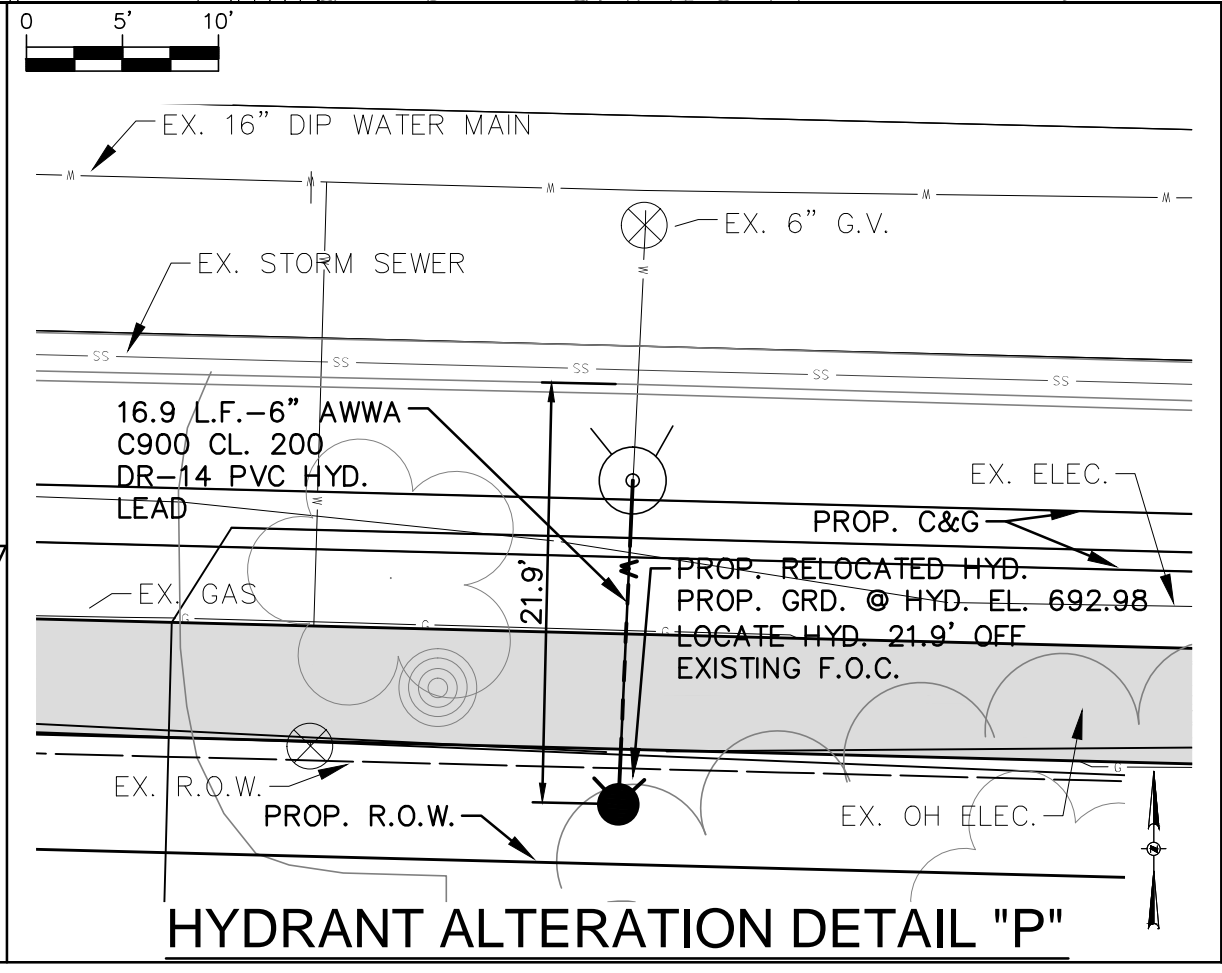
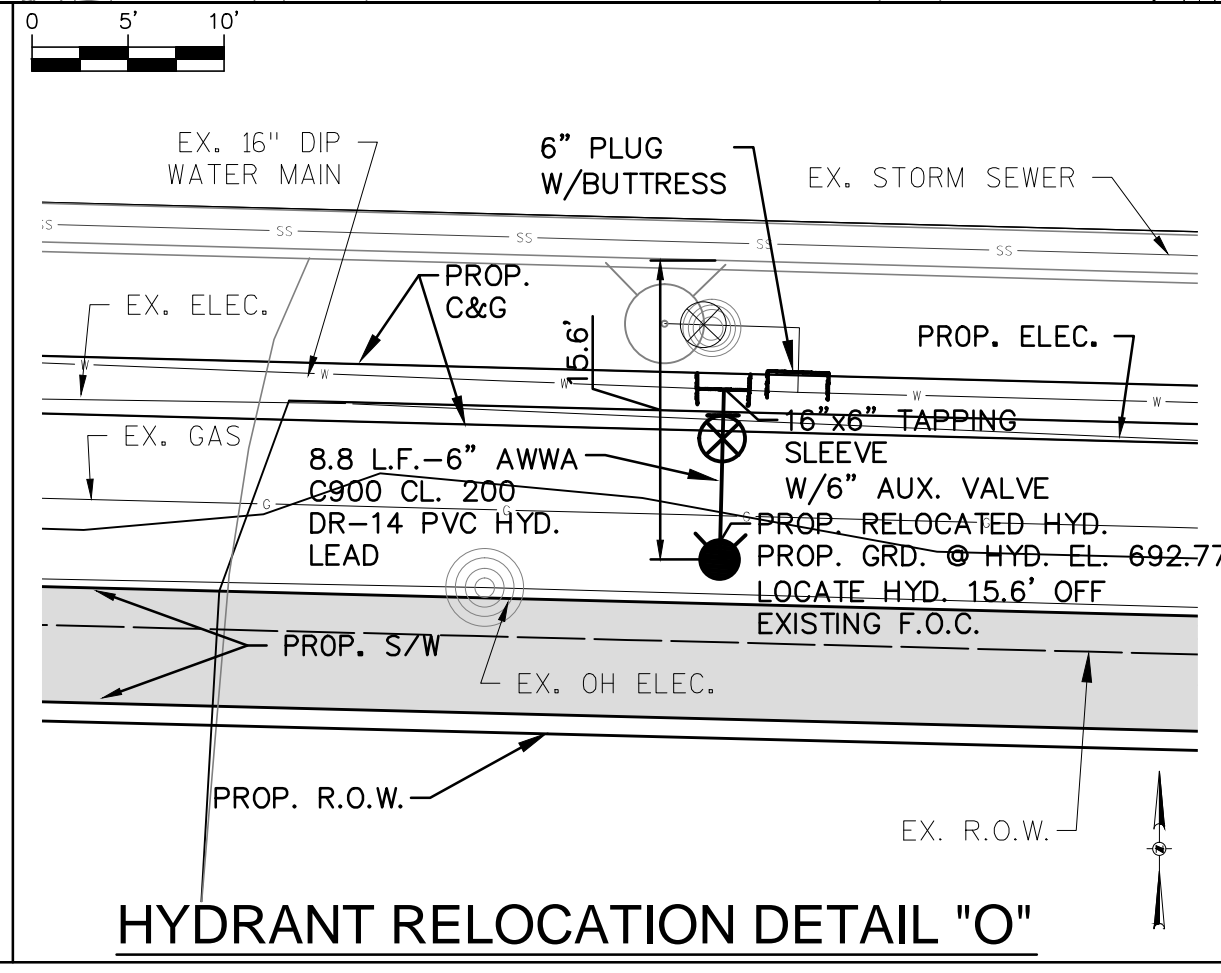
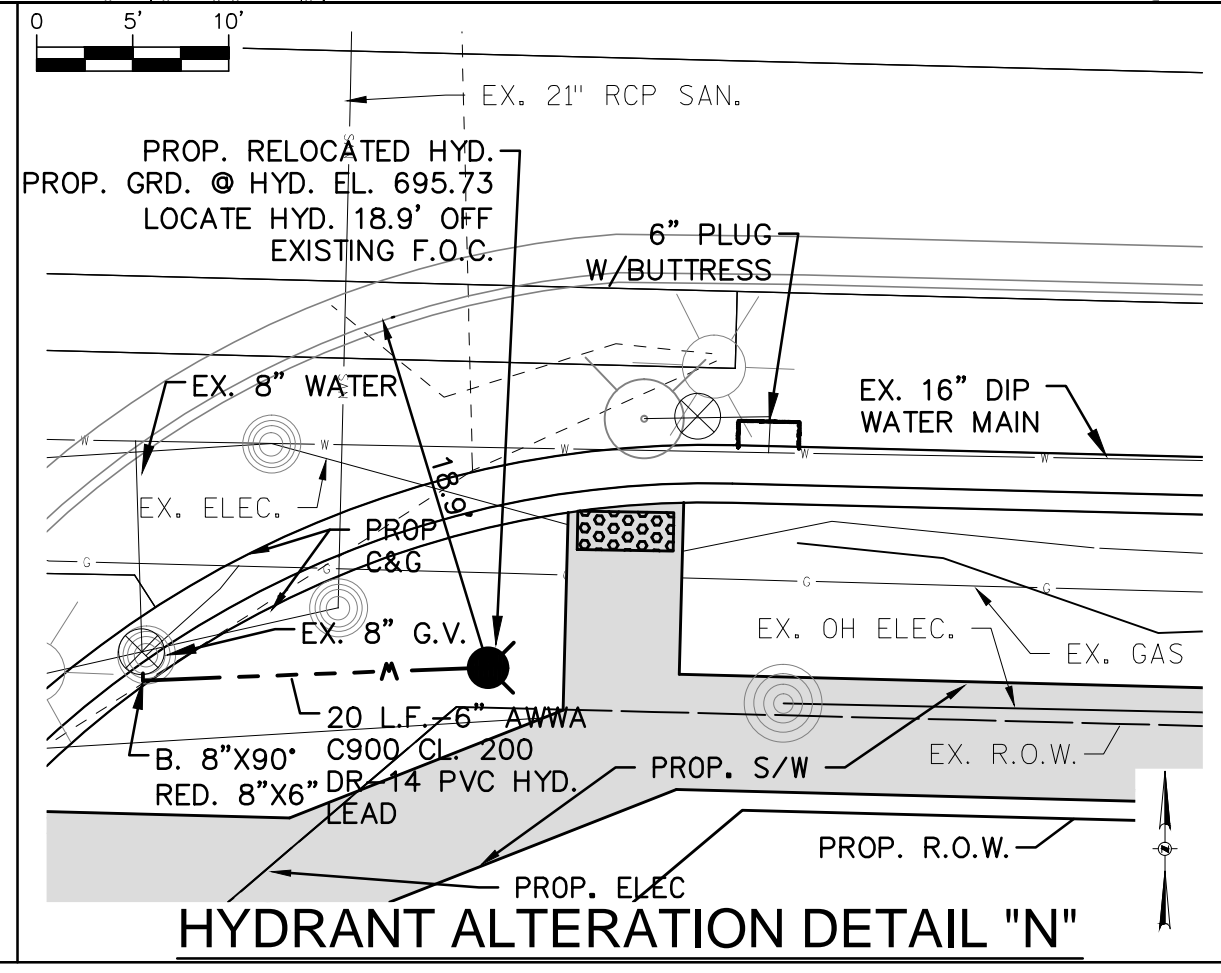
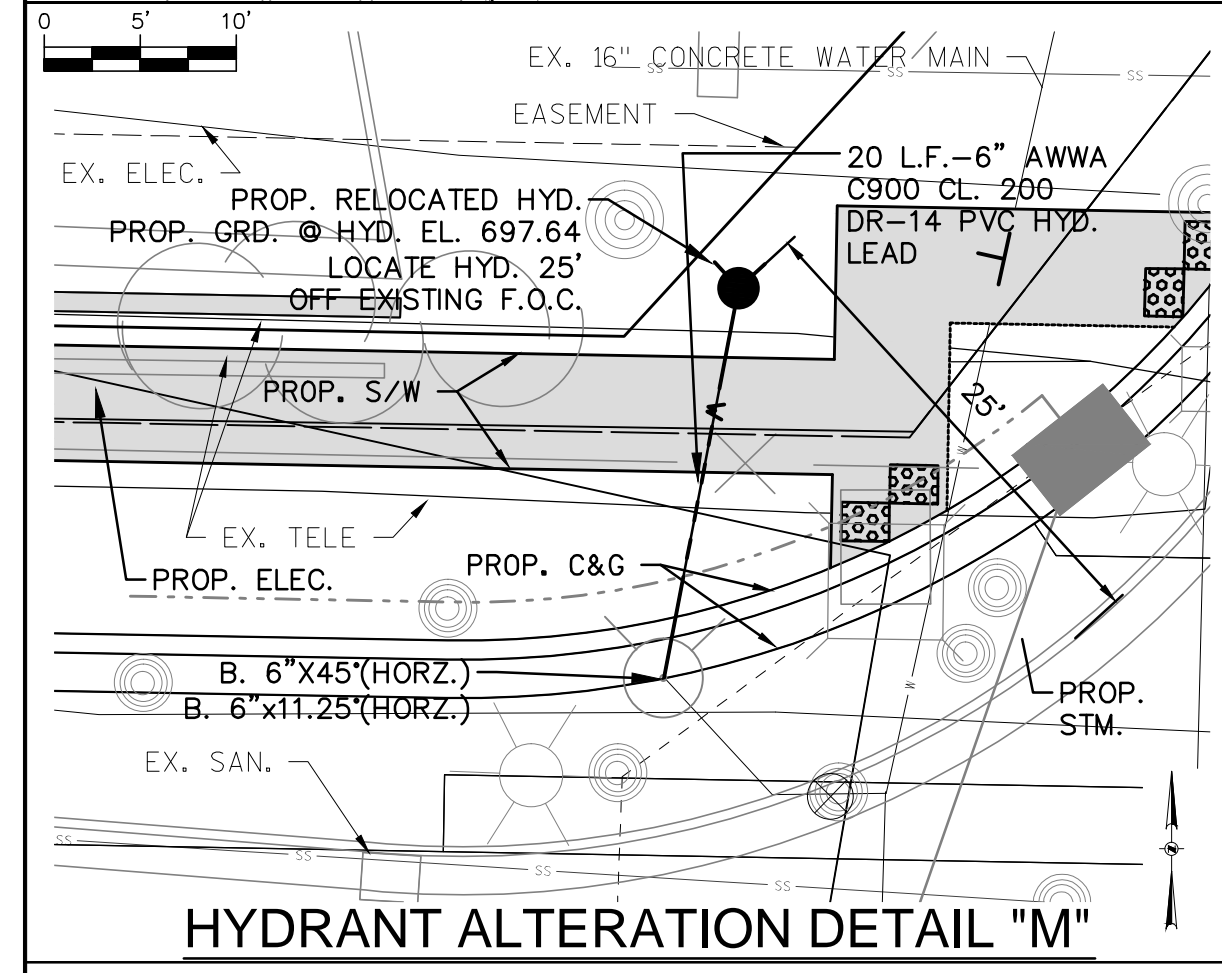
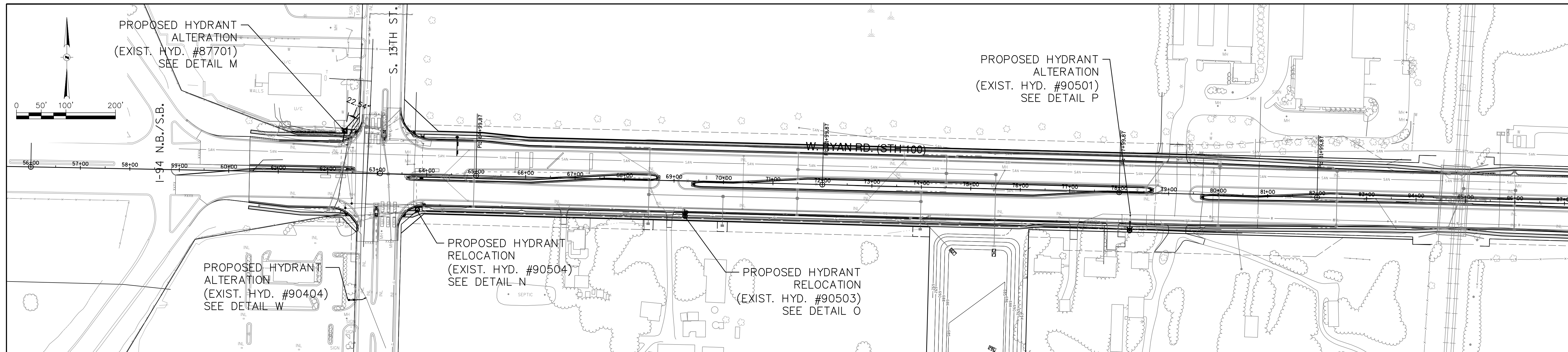

**LEGEND**

- X - STRUCTURE REMOVAL
- v- - PROPOSED WATER MAIN
- - PROPOSED HYDRANT
- - PROPOSED PLUG
- ⊗ - PROPOSED GATE VALVE
- - EXISTING HYDRANT
- ⊗ - EXISTING GATE VALVE

**NOTICE:**  
In accordance with Wisconsin statute 182.0175, damage to transmission facilities, excavator shall be solely responsible to provide advance notice to the designated "ONE CALL SYSTEM" not less than three working days prior to commencement of any excavation required to perform work contained on this drawing, and further, excavator shall comply with all other requirements of this statute relative to excavator's work.

**DISCLAIMER:**  
The underground utilities shown have been located from field survey information and existing drawings. The surveyor makes no guarantees that the underground utilities shown comprise all such utilities in the area, either in service or abandoned. The surveyor further does not warrant that the underground utilities shown are in the exact location indicated although he does certify that they are located as accurately as possible from information available. The surveyor has not physically located the underground utilities.

**GRAEF**  
One Honey Creek Corporate Center  
125 South 84th Street, Suite 401  
Milwaukee, WI 53214-1469  
414 / 259 1500  
414 / 259 0037 fax  
www.graef-usa.com

BID ITEM NOS.	ESTIMATE OF QUANTITIES	WATER MAIN CONTRACTOR:
1	Hydrant Relocation, including removing existing hydrants, valves, and pipe as needed, furnishing and installing new 6.0 foot hydrants, 6" C900 CL 200 DR-14 restrained water main pipe, 6" gate valve fittings, tapping sleeves, live tap to existing water main, buttresses, excavation, granular backfill and asphalt restoration as designated on the Drawings	SA.FKO ST.FKO W. FKO G. FKO E. FKO T. FKO I. FKO TS.FKO PP.
2	Hydrant alteration, including removing existing hydrants, valves, and pipe as needed, furnishing and installing new 6.0 foot hydrants, 6" C900 CL 200 DR-14 PVC restrained water main pipe fittings, provide and install anode protection, temporary plugs, caps, buttresses, flushing vents for testing and sampling, excavation, insulation, granular backfill and asphalt restoration as designated on the Drawings.	ADD 1 01/29/14

WATER MAIN CONTRACTOR:	SA.FKO
CONTRACTOR:	ST.FKO
MAINLINE INSPECTED BY:	W. FKO
LATERALS INSPECTED BY:	G. FKO
DATE COMPLETED:	E. FKO
TYPE OF PIPE, ASTM NO.	T. FKO
TYPE OF PIPE, ASTM NO.	I. FKO
AS-BUILTS BY:	TS.FKO
DATE:	PP.
This is to certify that this plan was approved by the Water Works and Sewer Utility Commission of Oak Creek at a regular meeting.	
Utility Engineer	Date

CITY OF OAK CREEK, WISCONSIN				APPROVED BY	
DESIGNED BY	DATE	DRAWN BY	DATE	UTILITY ENGINEER	DATE
AS	1-16-14	FKO	1-16-14	MNP	1-16-14
RYAN RD. RELAY AND HYDRANT RELOCATIONS					
IN: W. RYAN ROAD (STH 100)					
FR: I-94 S.B. / I-94 N.B.					
TO: 2400 FT. EAST OF S. 13TH STREET					
REVISION BY DATE				CITY ENGINEER DATE	
SCALE				SHEET	
KEY PLAN				OF	
HOR. 1"=100'				05	
DETAIL PLAN				OF	
HOR. 1"=10'				13	
FILE NO: 14104-5C-2200					

L:\as2013\20130326\_05\CAD\Sheet\00\WOODOT\_RyanC\_00\_01\_Ryan\_06.dwg 1/29/2014 2:06:20 PM 1500 DWG To PDF.plt

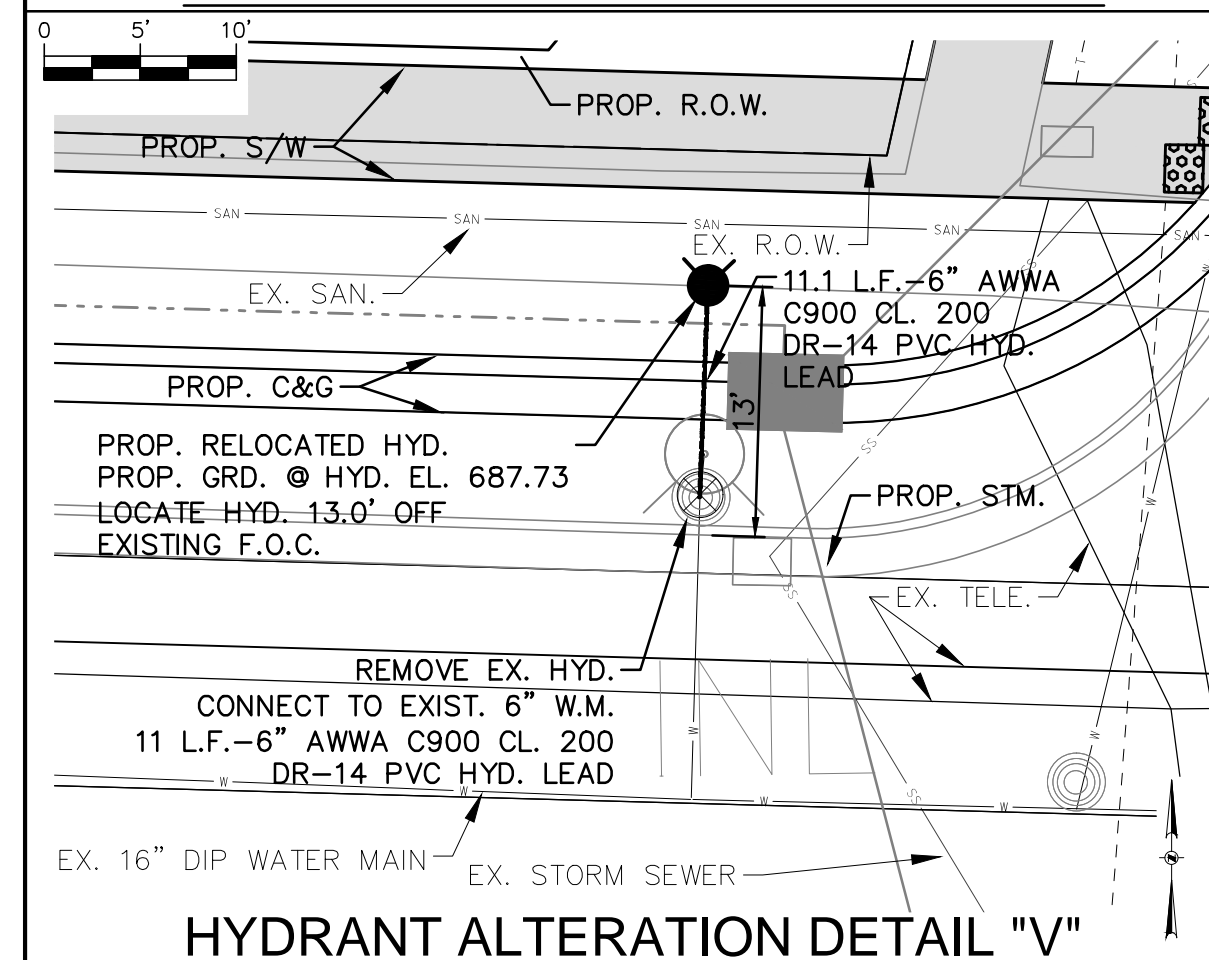
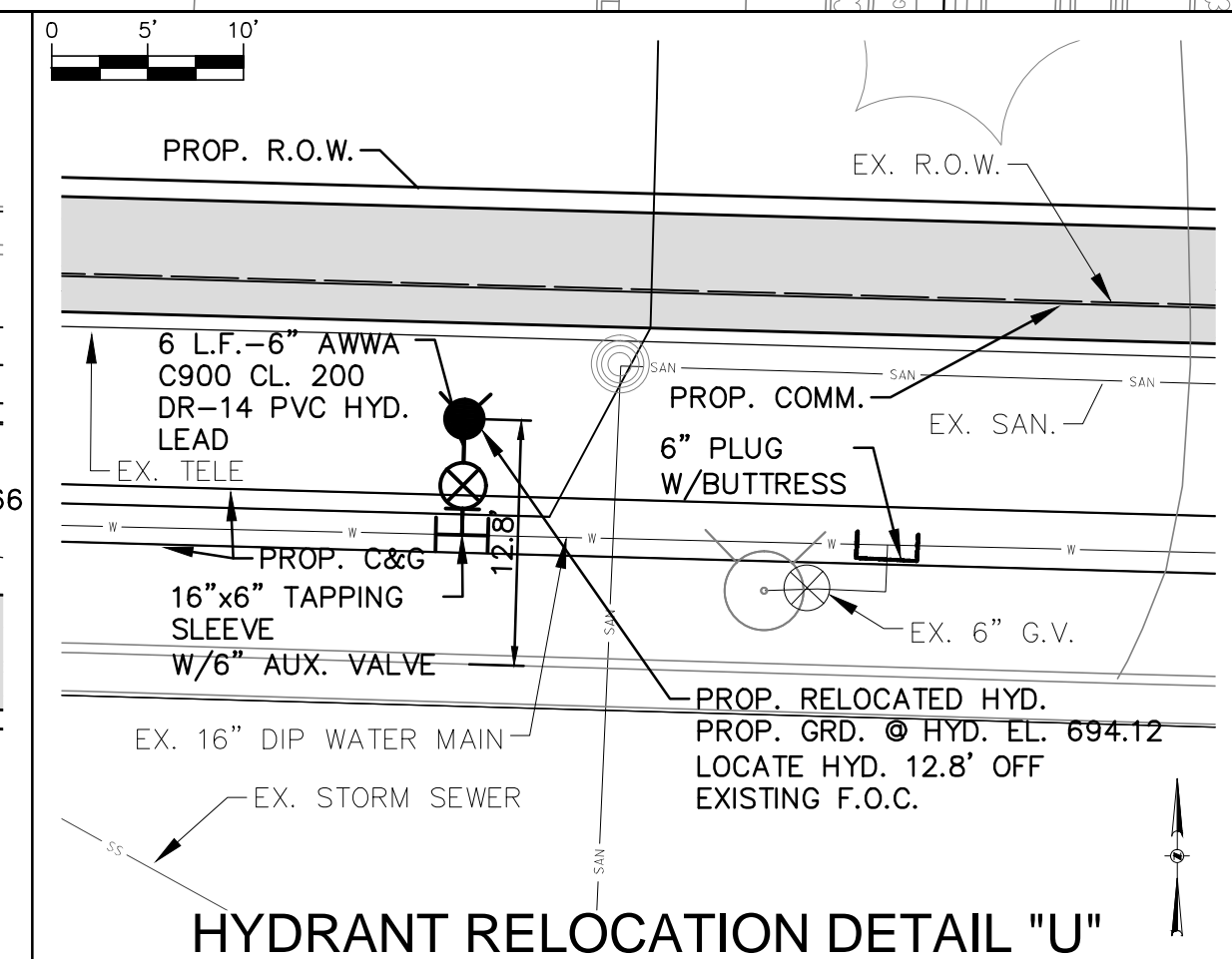
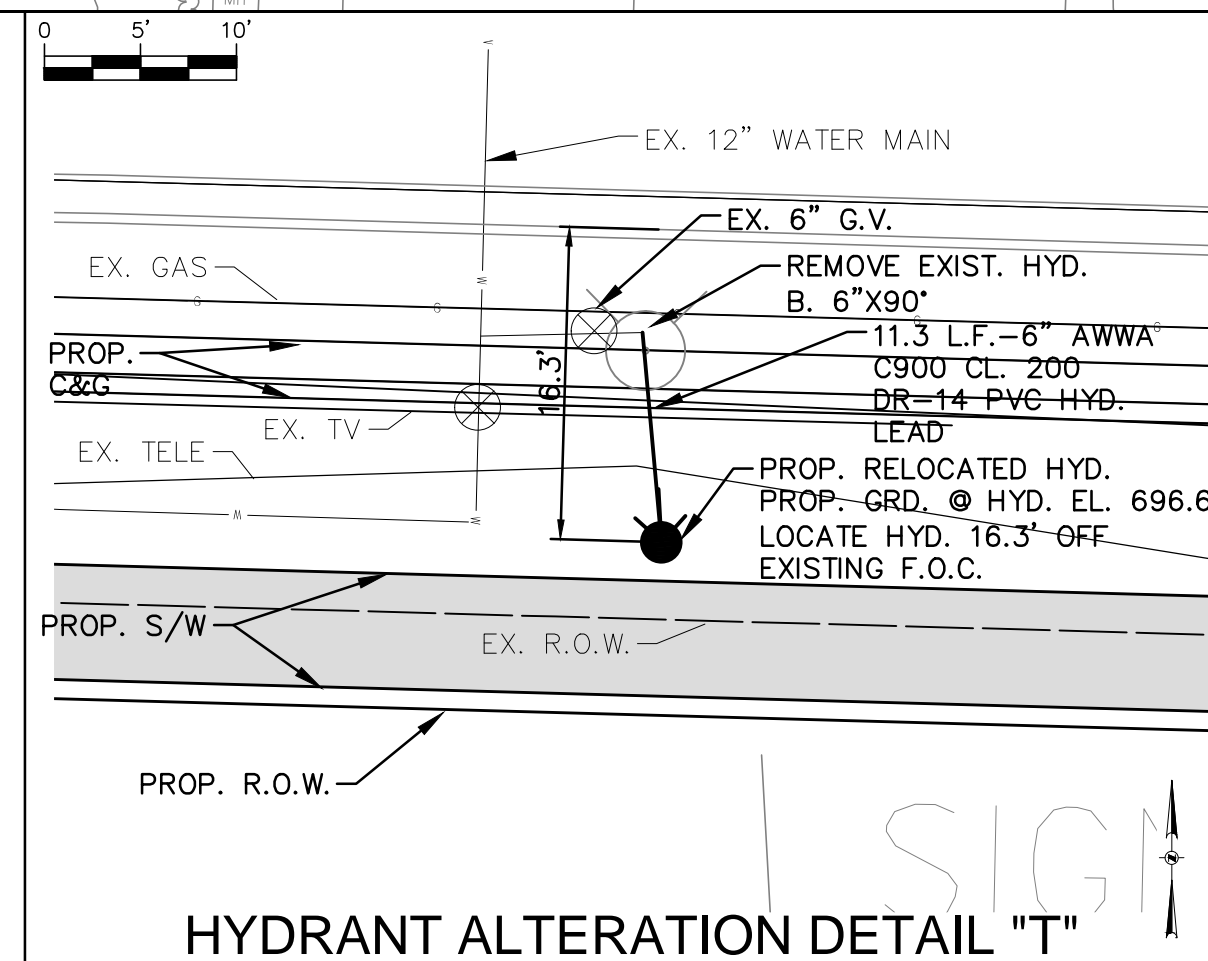
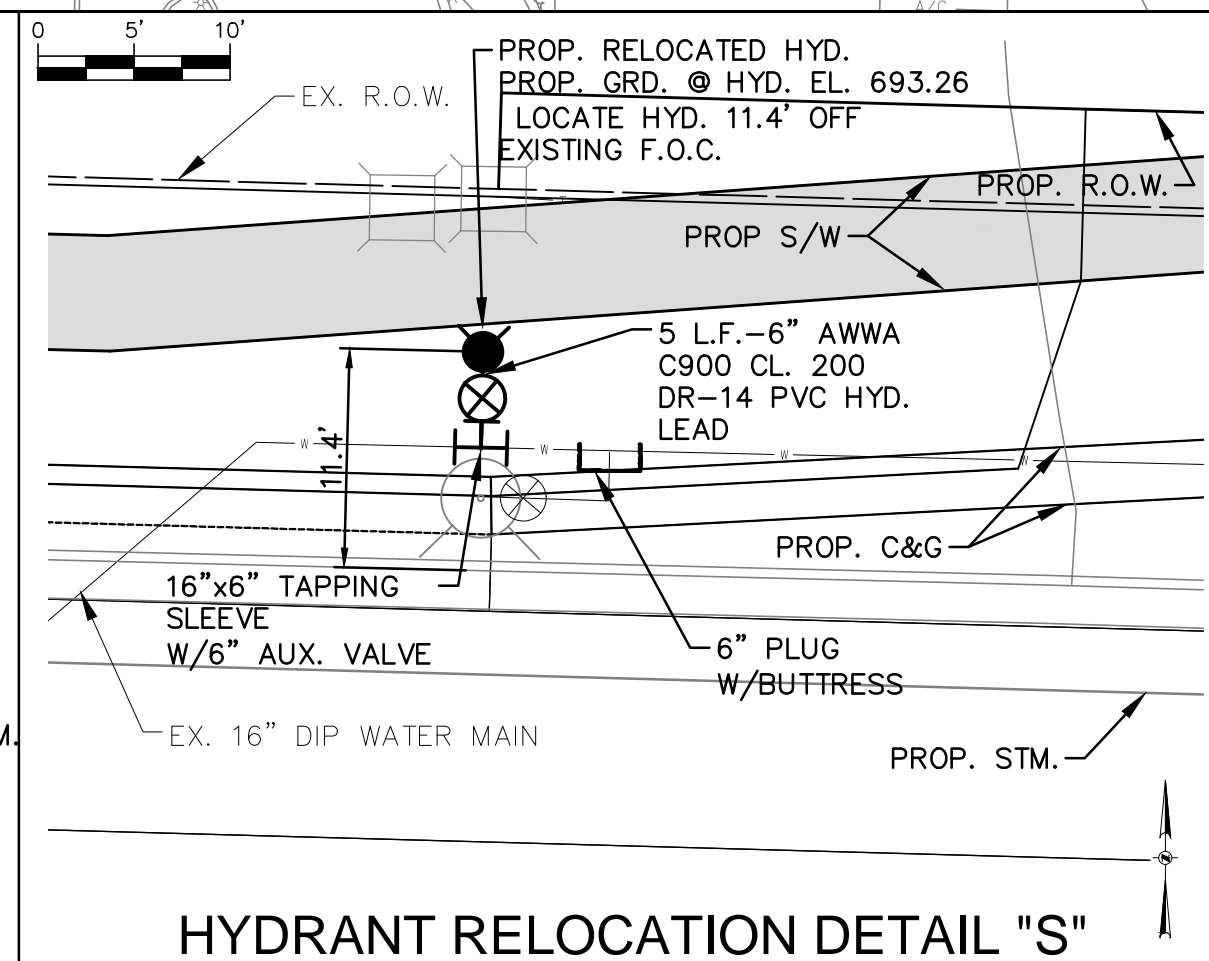
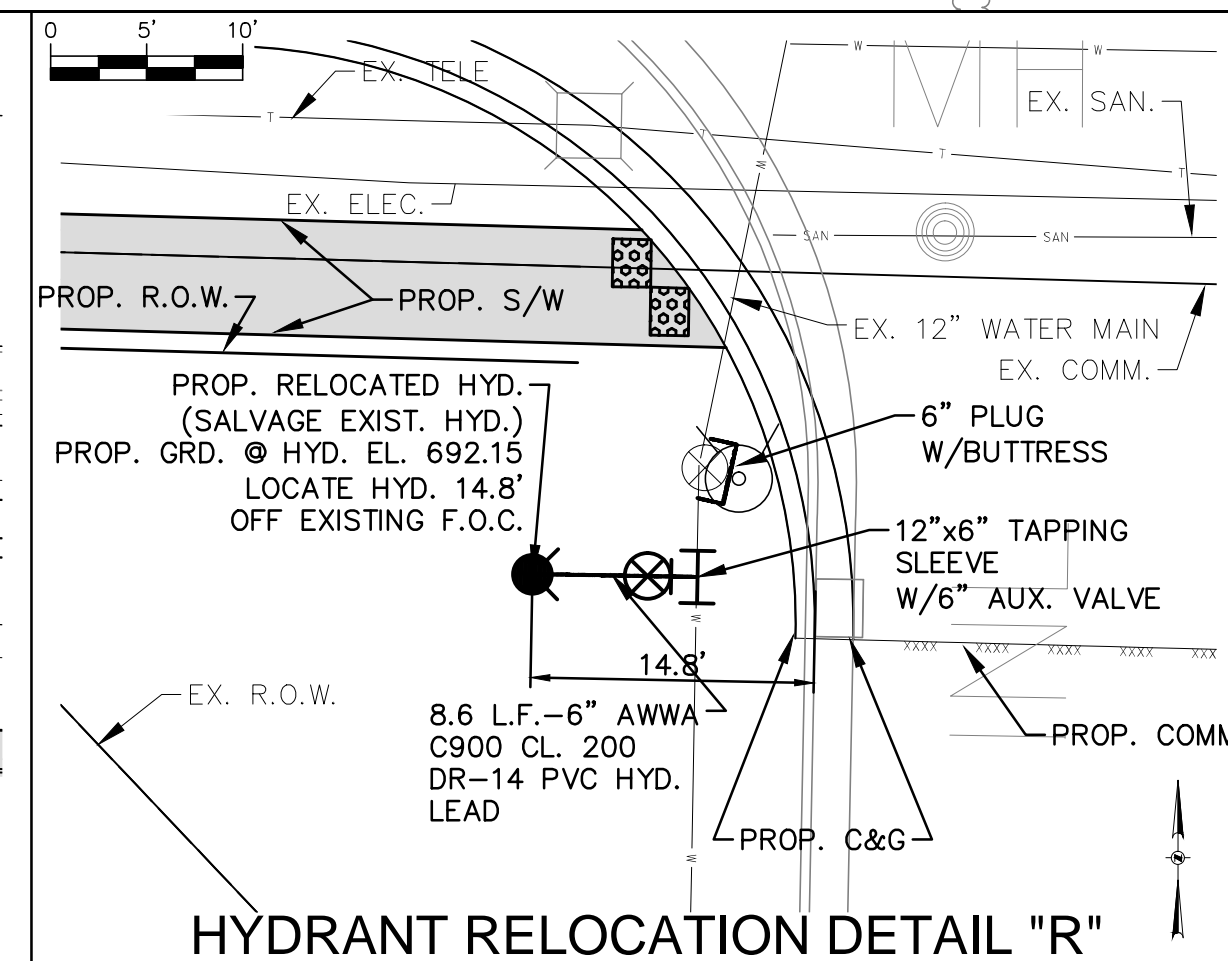
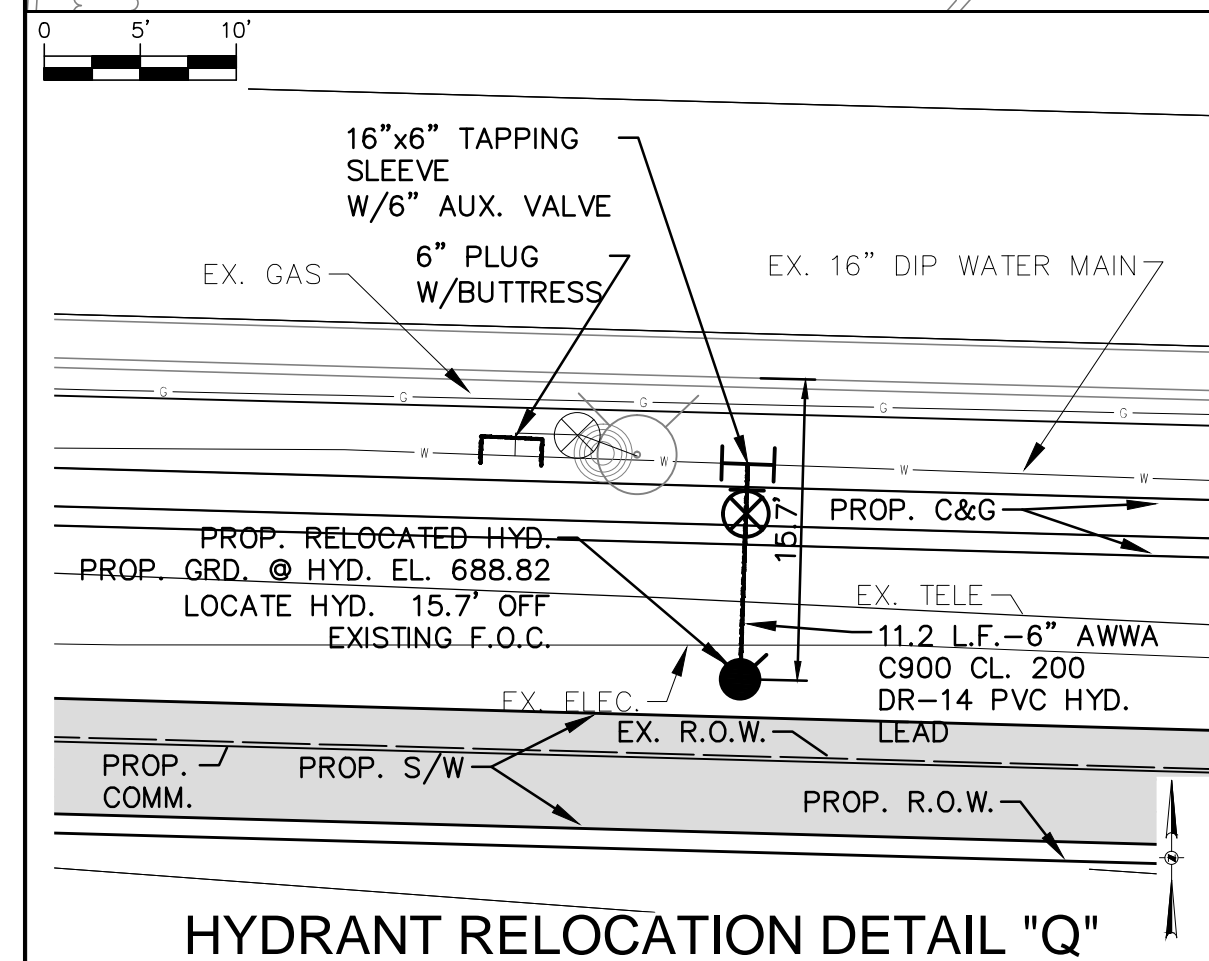
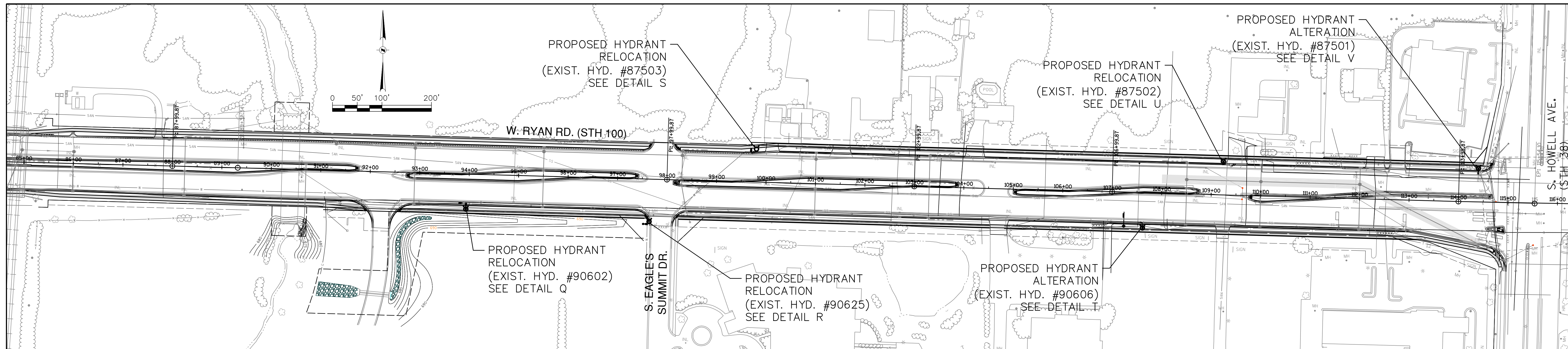

**LEGEND**

- X — STRUCTURE REMOVAL
- - - - - PROPOSED WATER MAIN
- — PROPOSED HYDRANT
- — PROPOSED PLUG
- ⊗ — PROPOSED GATE VALVE
- — EXISTING HYDRANT
- ⊗ — EXISTING GATE VALVE

BID ITEM NOS.	ESTIMATE OF QUANTITIES	WATER MAIN	SA.FKO
1	Hydrant Relocation, including removing existing hydrants, valves, and pipe as needed, furnishing and installing new 6.0 foot hydrants, 6" C900 CL 200 DR-14 restrained water main pipe, 6" gate valve fittings, tapping sleeves, live tap to existing water main, buttresses, excavation, insulation, granular backfill and asphalt restoration as designated on the Drawings	CONTRACTOR: MAINLINE INSPECTED BY: LATERALS INSPECTED BY: DATE COMPLETED: TYPE OF PIPE, ASTM NO. TYPE OF PIPE, ASTM NO.	ST.FKO W. FKO G. FKO E. FKO T. FKO I. FKO
2	Hydrant alteration, including removing existing hydrants, valves, and pipe as needed, furnishing and installing new 6.0 foot hydrants, 6" C900 CL 200 DR-14 PVC restrained water main pipe fittings, provide and install anode protection, temporary plugs, caps, buttresses, flushing vents for testing and sampling, excavation, insulation, granular backfill and asphalt restoration as designated on the Drawings.	AS-BUILTS BY: _____ DATE: _____ This is to certify that this plan was approved by the Water Works and Sewer Utility Commission of Oak Creek at a regular meeting.	TS.FKO PP.

Utility Engineer	Date
ADD 1	01/29/14
REVISION BY	DATE

CITY OF OAK CREEK, WISCONSIN				APPROVED BY	
DESIGNED BY	DATE	DRAWN BY	DATE	CHECKED BY	DATE
AS	1-16-14	FKO	1-16-14	MNP	1-16-14
RYAN RD. RELAY AND HYDRANT RELOCATIONS					
IN: W. RYAN ROAD (STH 100)					
FR: 500 FT. WEST OF S. EAGLES SUMMIT DR.					
TO: S. HOWELL AVE.					
				CITY ENGINEER	DATE
				SCALE	SHEET
				KEY PLAN	06
				DETAIL PLAN	OF
				HOR. 1"=10'	13
FILE NO: 14104-6C-2201					

**NOTICE:**  
In accordance with Wisconsin statute 182.0175, damage to transmission facilities, excavator shall be solely responsible to provide advance notice to the designated "ONE CALL SYSTEM" not less than three working days prior to commencement of any excavation required to perform work contained on this drawing, and further, excavator shall comply with all other requirements of this statute relative to excavator's work.

**DISCLAIMER:**  
The underground utilities shown have been located from field survey information and existing drawings. The surveyor makes no guarantee that the underground utilities shown comprise all such utilities in the area, either in service or abandoned. The surveyor further does not warrant that the underground utilities shown are in the exact location indicated although he does certify that they are located as accurately as possible from information available. The surveyor has not physically located the underground utilities.

**GRAEF**  
One Honey Creek Corporate Center  
125 South 84th Street, Suite 401  
Milwaukee, WI 53214-1469  
414 / 259 1500  
414 / 259 0037 fax  
www.graef-usa.com

L:\as2013\20130326\_05\CAD\SSA\dwg\WOODOT\_RyanC\_00\_01\_Ryan\_06.dwg 1/29/2014 2:07:05 PM 1500 DWG To PDF.dwg

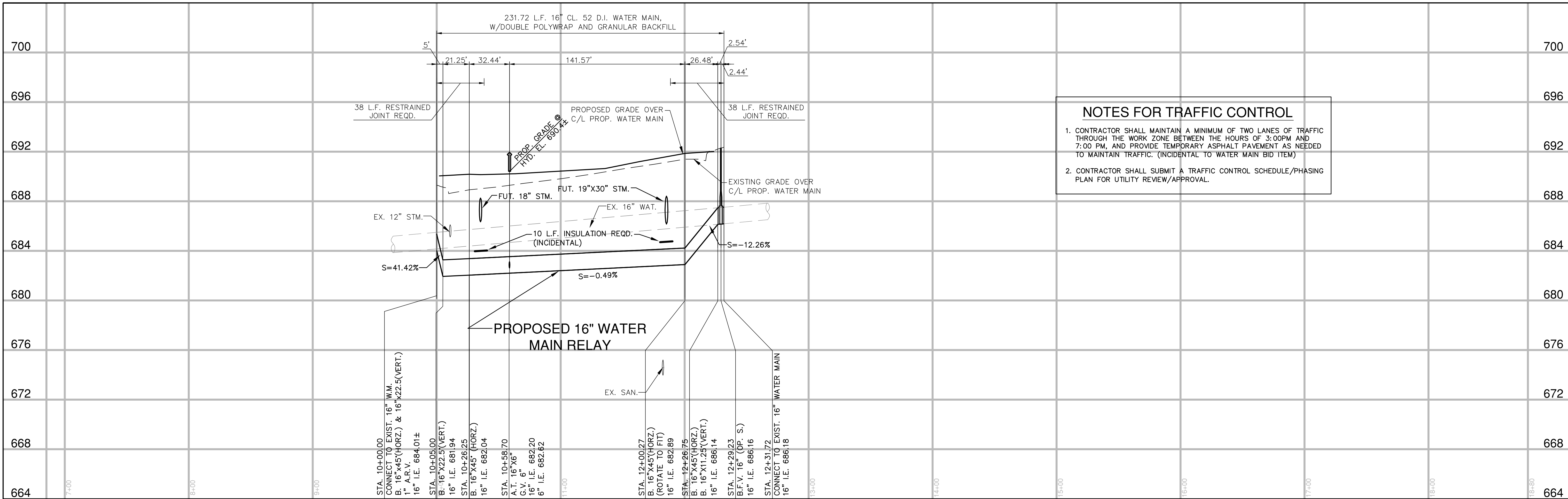

**NOTES FOR TRAFFIC CONTROL**

- CONTRACTOR SHALL MAINTAIN A MINIMUM OF TWO LANES OF TRAFFIC THROUGH THE WORK ZONE BETWEEN THE HOURS OF 3:00PM AND 7:00 PM, AND PROVIDE TEMPORARY ASPHALT PAVEMENT AS NEEDED TO MAINTAIN TRAFFIC. (INCIDENTAL TO WATER MAIN BID ITEM)
- CONTRACTOR SHALL SUBMIT A TRAFFIC CONTROL SCHEDULE/PHASING PLAN FOR UTILITY REVIEW/APPROVAL.

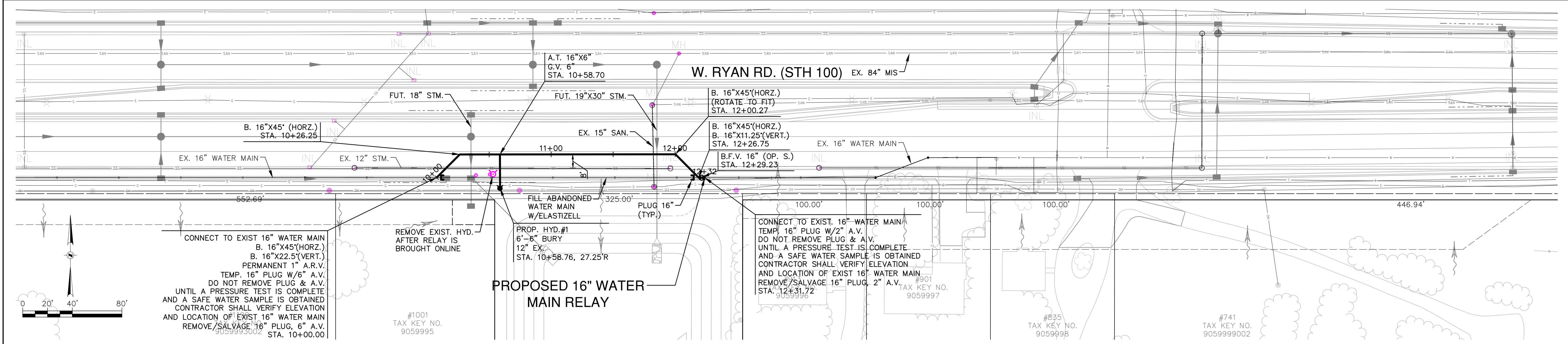

CONNECT TO EXIST 16" WATER MAIN  
B. 16"x45"(HORZ.)  
B. 16"x22.5"(VERT.)  
PERMANENT 1" A.R.V.  
TEMP. 16" PLUG W/6" A.V.  
DO NOT REMOVE PLUG & A.V.  
UNTIL A PRESSURE TEST IS COMPLETE  
AND A SAFE WATER SAMPLE IS OBTAINED  
CONTRACTOR SHALL VERIFY ELEVATION  
AND LOCATION OF EXIST 16" WATER MAIN  
REMOVE/SALVAGE 16" PLUG, 6" A.V.  
STA. 10+00.00

**PROPOSED 16" WATER MAIN RELAY**

CONNECT TO EXIST. 16" WATER MAIN  
TEMP. 16" PLUG W/2" A.V.  
DO NOT REMOVE PLUG & A.V.  
UNTIL A PRESSURE TEST IS COMPLETE  
AND A SAFE WATER SAMPLE IS OBTAINED  
CONTRACTOR SHALL VERIFY ELEVATION  
AND LOCATION OF EXIST 16" WATER MAIN  
REMOVE/SALVAGE 16" PLUG, 2" A.V.  
STA. 12+31.72

ESTIMATE OF QUANTITIES		WATER MAIN	SAFKO
BID ITEM NOS.	DESCRIPTION	CONTRACTOR:	ST.FKO
1	16-inch class 52 ductile iron, double polywrapped, Water Main with granular backfill, full depth sawcutting, concrete pavement removal, asphalt pavement replacement, asphalt curb and gutter replacement, lawn restoration.	232 L.F.	W. FKO
2	16-inch Butterfly Valve	1 EA.	G. FKO
3	Permanent 1-inch Air Release Valve	1 EA.	E. FKO
4	Connect to Existing 16" Water Main, Provide and install anode protection.	2 EA.	T. FKO
5	Hydrant, Lead, 6-inch Gate Valve, and extension.	1 EA.	I. FKO

CITY OF OAK CREEK, WISCONSIN	
DESIGNED BY	DATE
AS	1-16-14
DRAWN BY	DATE
FKO	1-16-14
CHECKED BY	DATE
MNP	1-16-14
W. RYAN RD. (STH 100) PROPOSED WATER MAIN RELAY	
IN: W. RYAN RD. (STH 100)	
FR: 990 FT. EAST OF S. 13TH ST.	
TO: 1695 FT. EAST OF S. 13TH ST.	
REVISION BY	DATE
ADD 1	01/29/14

APPROVED BY	
UTILITY ENGINEER	DATE
APPROVED BY	
CITY ENGINEER	DATE
SCALE	SHEET
PLAN HOR. 1"=40'	07
PROFILE HOR. 1"=40'	OF
VER. 1"=4'	13

**GRÄEF**  
One Honey Creek Corporate Center  
125 South 84th Street, Suite 401  
Milwaukee, WI 53214-1469  
414 / 259 1500  
414 / 259 0037 fax  
www.graef-usa.com

L:\Users\13101\30356\96\CAD\Sheet\dwg\01\_00\_Ryan\_350\06.dwg, 1/29/2014 2:28:03 PM, 1500, DWG to PDF, #3

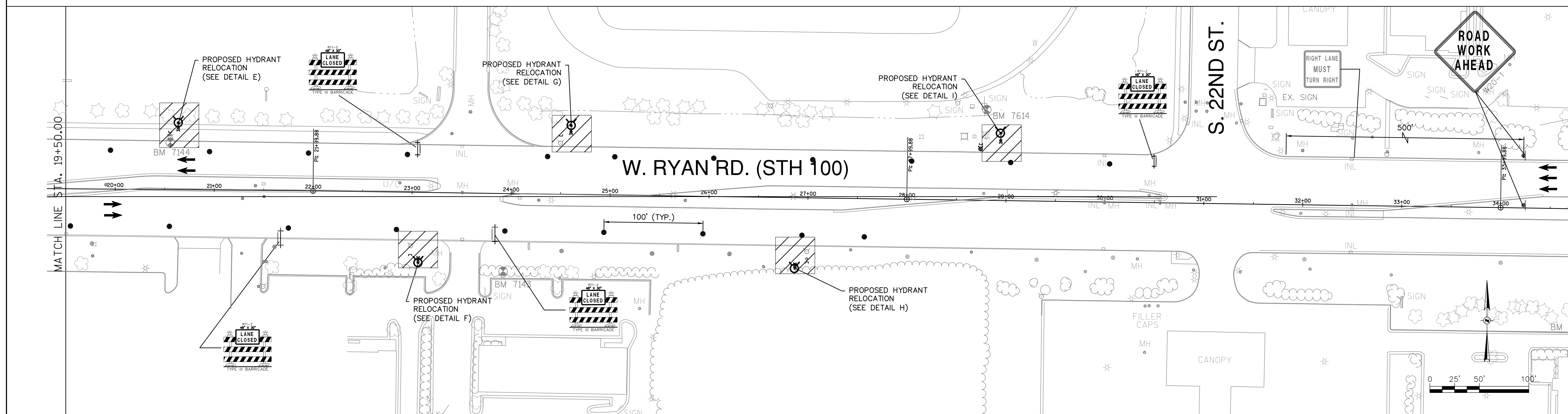
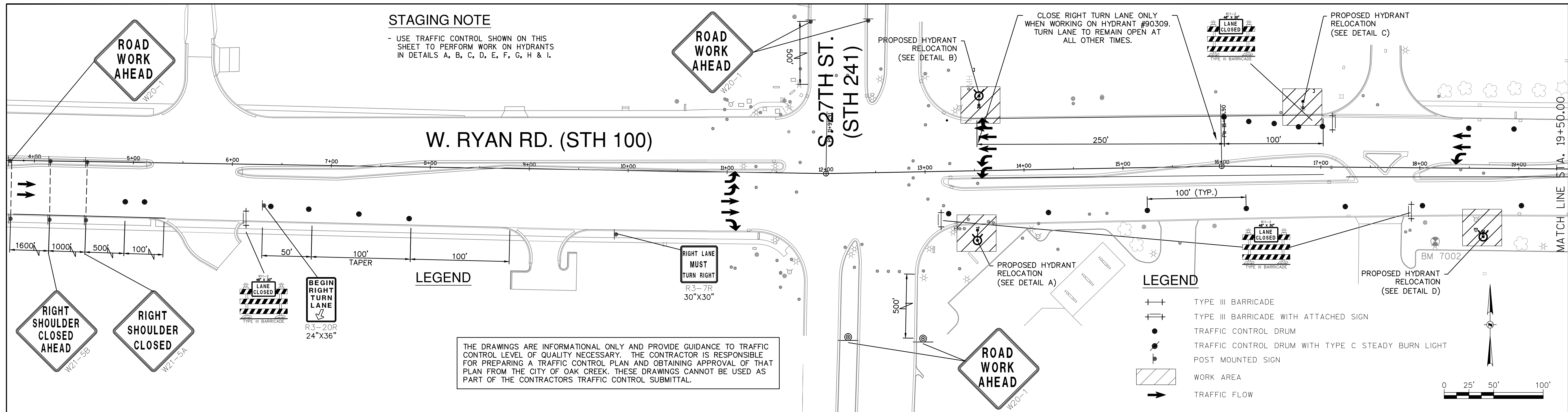

**GRÄEF**  
 One Honey Creek Corporate Center  
 125 South 84th Street, Suite 401  
 Milwaukee, WI 53214-1469  
 414 / 259 1500  
 414 / 259 0037 fax  
 www.graef-usa.com

BID ITEM NOS.	ESTIMATE OF QUANTITIES

<b>WATER MAIN</b>	<b>SA.FKO</b>
CONTRACTOR:	ST.FKO
MAINLINE INSPECTED BY:	W. FKO
LATERALS INSPECTED BY:	G. FKO
DATE COMPLETED:	E. FKO
TYPE OF PIPE, ASTM NO.	T. FKO
TYPE OF PIPE, ASTM NO.	I. FKO
AS-BUILTS BY:	TS.FKO
DATE:	PP.
This is to certify that this plan was approved by the Water Works and Sewer Utility Commission of Oak Creek at a regular meeting.	
Utility Engineer	Date
ADD 1	01/29/14
REVISION BY	DATE

<b>CITY OF OAK CREEK, WISCONSIN</b>				APPROVED BY	
DESIGNED BY	DATE	DRAWN BY	DATE	CHECKED BY	DATE
AS	1-16-14	FKO	1-16-14	MNP	1-16-14
<b>W. RYAN RD. TRAFFIC CONTROL STAGE 1</b> <b>IN: W. RYAN ROAD (STH 100)</b> FR: 865 FT. EAST OF S. 27TH ST. TO: 360 FT. WEST OF S. 22ND ST.					
CITY ENGINEER				DATE	
SCALE				SHEET	
PLAN				08	
HOR. 1"=50'				OF	
				13	
FILE NO: 14104-8C-2203					

L:\basin\1301\0336\06\CAD\Sheet\DWG\W001\_RyanC\_06.dwg, 1/29/2014 2:08:29 PM, 1500, DWG To PDF, p23



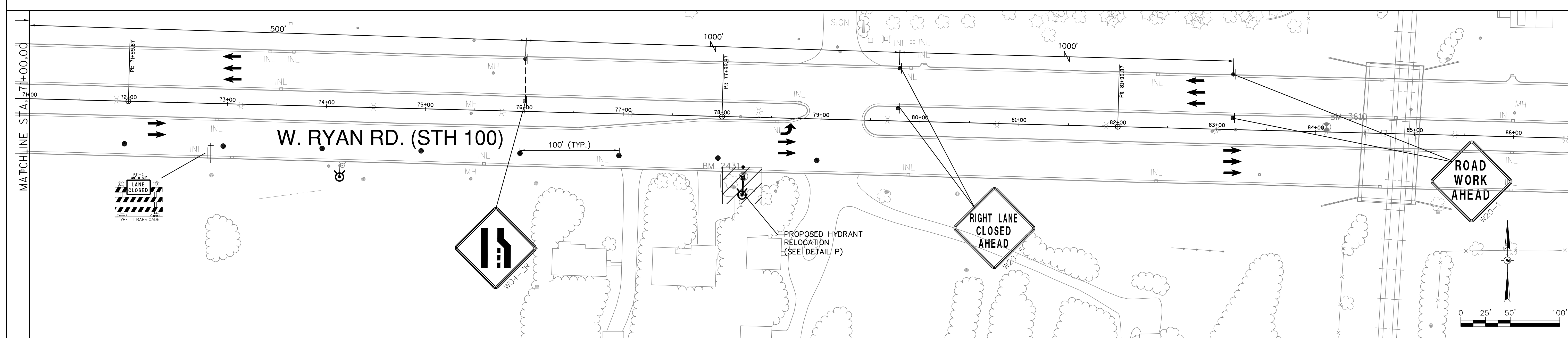
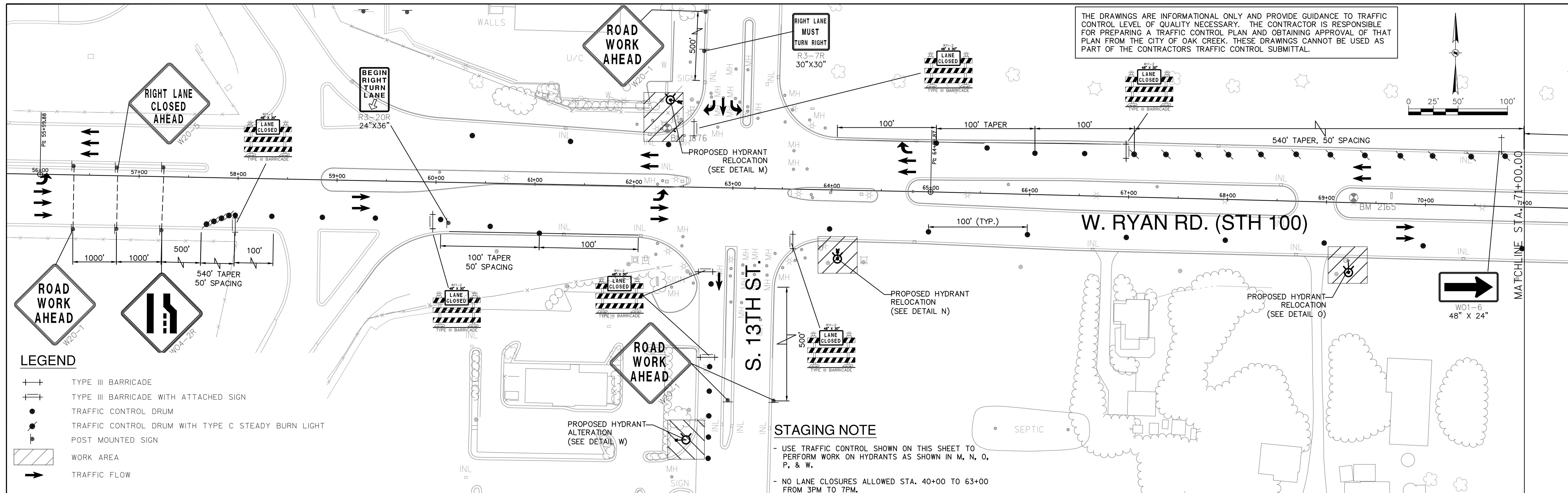

**NOTICE:**  
In accordance with Wisconsin statute 182.0175, damage to transmission facilities, excavator shall be solely responsible to provide advance notice to the designated "ONE CALL SYSTEM" not less than three working days prior to commencement of any excavation required to perform work contained on this drawing, and further, excavator shall comply with all other requirements of this statute relative to excavator's work.

**DISCLAIMER:**  
The underground utilities shown have been located from field survey information and existing drawings. The surveyor makes no guarantee that the underground utilities shown comprise all such utilities in the area, either in service or abandoned. The surveyor further does not warrant that the underground utilities shown are in the exact location indicated although he does certify that they are located as accurately as possible from information available. The surveyor has not physically located the underground utilities.

**GRAEF**  
One Honey Creek Corporate Center  
125 South 84th Street, Suite 401  
Milwaukee, WI 53214-1469  
414 / 259 1500  
414 / 259 0037 fax  
www.graef-usa.com

BID ITEM NOS.	ESTIMATE OF QUANTITIES

<b>WATER MAIN</b>	SA.FKO
CONTRACTOR:	ST.FKO
MAINLINE INSPECTED BY:	W. FKO
LATERALS INSPECTED BY:	G. FKO
DATE COMPLETED:	E. FKO
TYPE OF PIPE, ASTM NO.	T. FKO
TYPE OF PIPE, ASTM NO.	I. FKO
AS-BUILTS BY:	TS.FKO
DATE:	PP.
This is to certify that this plan was approved by the Water Works and Sewer Utility Commission of Oak Creek at a regular meeting.	
Utility Engineer	Date
ADD 1	01/29/14
REVISION BY	DATE

<b>CITY OF OAK CREEK, WISCONSIN</b>			APPROVED BY		
DESIGNED BY	DATE	DRAWN BY	DATE	CHECKED BY	DATE
AS	1-16-14	FKO	1-16-14	MNP	1-16-14
<b>W. RYAN RD. TRAFFIC CONTROL STAGE 3A</b>					
<b>IN: W. RYAN ROAD (STH 100)</b>					
FR: I-94 S.B. / I-94 N.B.					
TO: 2700 FT. WEST OF I-94 S.B. / I-94 N.B.					
PLAN HOR. 1"=50'			SCALE SHEET		
			10 OF 13		
FILE NO: 14104-10C-2205					

L:\as2013\20130326\06\CAD\Sheet\DWG\W001\_RyanC\_06.dwg, 1/29/2014 2:08:57 PM, 1500, DWG To PDF, p.3

**LEGEND**

- ⊥ ⊥ TYPE III BARRICADE
- ⊥ ⊥ TYPE III BARRICADE WITH ATTACHED SIGN
- TRAFFIC CONTROL DRUM
- TRAFFIC CONTROL DRUM WITH TYPE C STEADY BURN LIGHT
- ⊥ POST MOUNTED SIGN
- ▨ WORK AREA
- TRAFFIC FLOW
- ↔ FLASHING ARROW BOARD

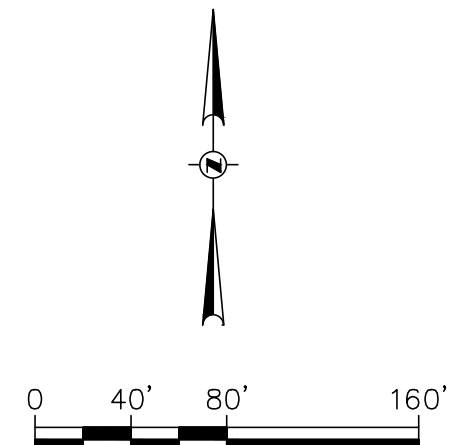

THE DRAWINGS ARE INFORMATIONAL ONLY AND PROVIDE GUIDANCE TO TRAFFIC CONTROL LEVEL OF QUALITY NECESSARY. THE CONTRACTOR IS RESPONSIBLE FOR PREPARING A TRAFFIC CONTROL PLAN AND OBTAINING APPROVAL OF THAT PLAN FROM THE CITY OF OAK CREEK. THESE DRAWINGS CANNOT BE USED AS PART OF THE CONTRACTORS TRAFFIC CONTROL SUBMITTAL.

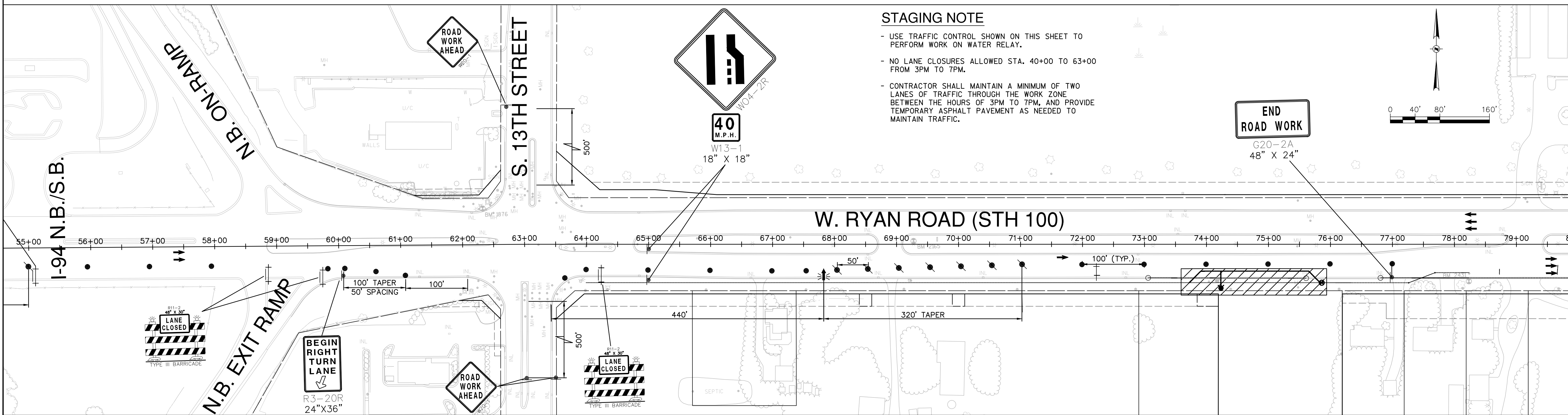
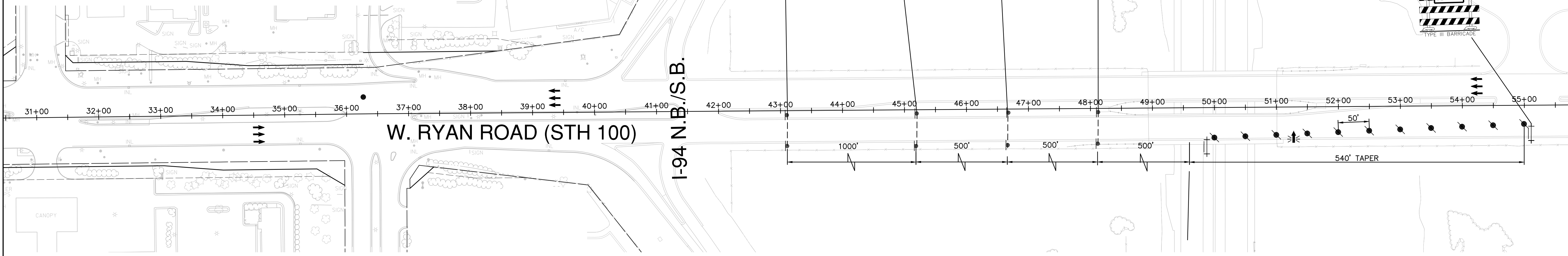

**STAGING NOTE**

- USE TRAFFIC CONTROL SHOWN ON THIS SHEET TO PERFORM WORK ON WATER RELAY.
- NO LANE CLOSURES ALLOWED STA. 40+00 TO 63+00 FROM 3PM TO 7PM.
- CONTRACTOR SHALL MAINTAIN A MINIMUM OF TWO LANES OF TRAFFIC THROUGH THE WORK ZONE BETWEEN THE HOURS OF 3PM TO 7PM, AND PROVIDE TEMPORARY ASPHALT PAVEMENT AS NEEDED TO MAINTAIN TRAFFIC.

NOTICE:  
In accordance with Wisconsin statute 182.0175, damage to transmission facilities, excavator shall be solely responsible to provide advance notice to the designated "ONE CALL SYSTEM" not less than three working days prior to commencement of any excavation required to perform work contained on this drawing, and further, excavator shall comply with all other requirements of this statute relative to excavator's work.

DISCLAIMER:  
The underground utilities shown have been located from field survey information and existing drawings. The surveyor makes no guarantees that the underground utilities shown comprise all such utilities in the area, either in service or abandoned. The surveyor further does not warrant that the underground utilities shown are in the exact location indicated although he does certify that they are located as accurately as possible from information available. The surveyor has not physically located the underground utilities.

**GRAEF**  
One Honey Creek Corporate Center  
125 South 84th Street, Suite 401  
Milwaukee, WI 53214-1469  
414 / 259 1500  
414 / 259 0037 fax  
www.graef-usa.com

BID ITEM NOS.	ESTIMATE OF QUANTITIES

<b>WATER MAIN</b>	SA.FKO
CONTRACTOR:	ST.FKO
MAINLINE INSPECTED BY:	W. FKO
LATERALS INSPECTED BY:	G. FKO
DATE COMPLETED:	E. FKO
TYPE OF PIPE, ASTM NO.	T. FKO
TYPE OF PIPE, ASTM NO.	I. FKO
AS-BUILTS BY:	TS.FKO
DATE:	PP.
This is to certify that this plan was approved by the Water Works and Sewer Utility Commission of Oak Creek at a regular meeting.	
Utility Engineer	Date
ADD 1	01/29/14
REVISION BY	DATE

<b>CITY OF OAK CREEK, WISCONSIN</b>			APPROVED BY		
DESIGNED BY	DATE	DRAWN BY	DATE	UTILITY ENGINEER	DATE
AS	1-16-14	FKO	1-16-14	MNP	1-16-14
W. RYAN RD. TRAFFIC CONTROL STAGE 3B					
IN: W. RYAN ROAD (STH 100)					
FR: 1000 FT. WEST OF I-94 S.B./N.B.					
TO: 1900 FT. EAST OF S. 13TH ST.					
CITY ENGINEER				DATE	
SCALE				SHEET	
PLAN HOR. 1"=80'				11	
PROFILE HOR.				OF	
VER.				13	
FILE NO: 14104-11C-2206					

L:\basin\1301\0356\06\CAD\Submittal\00C\_00\_RyanTC\_350106.dwg, 1/29/2014 2:09:21 PM, 1500, DWG to PDF, p23



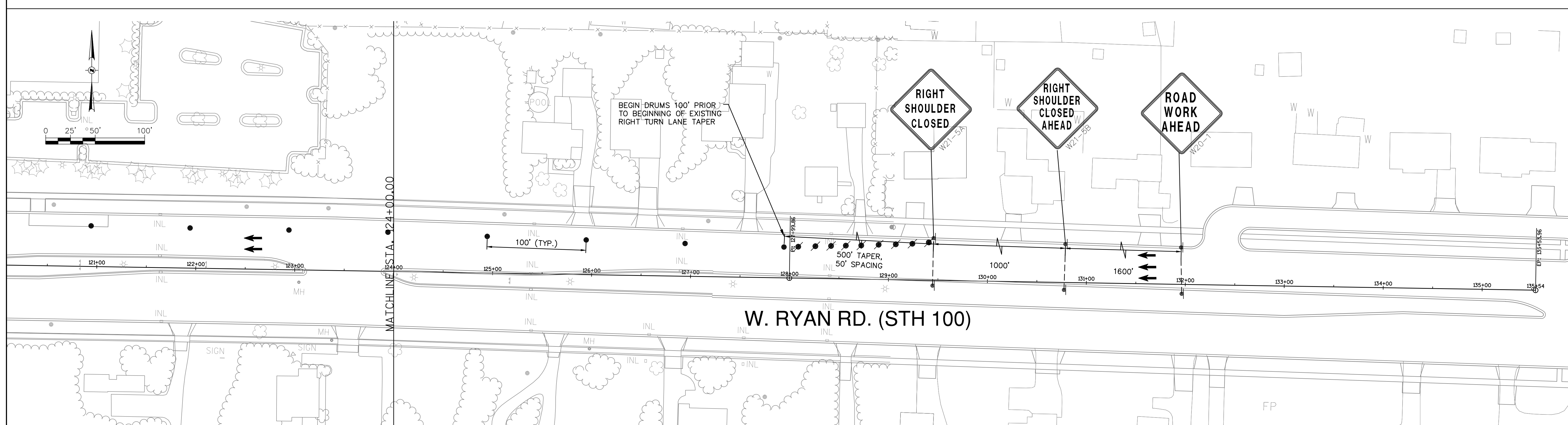
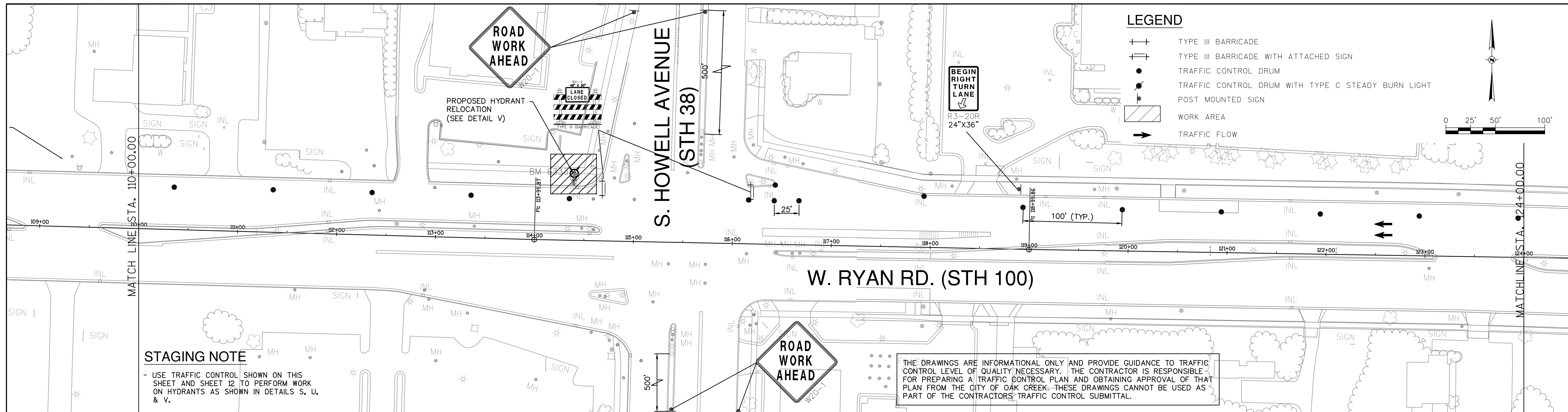

NOTICE:  
In accordance with Wisconsin statute 182.0175, damage to transmission facilities, excavator shall be solely responsible to provide advance notice to the designated "ONE CALL SYSTEM" not less than three working days prior to commencement of any excavation required to perform work contained on this drawing, and further, excavator shall comply with all other requirements of this statute relative to excavator's work.

DISCLAIMER:  
The underground utilities shown have been located from field survey information and existing drawings. The surveyor makes no guarantee that the underground utilities shown comprise all such utilities in the area, either in service or abandoned. The surveyor further does not warrant that the underground utilities shown are in the exact location indicated although he does certify that they are located as accurately as possible from information available. The surveyor has not physically located the underground utilities.

**GRAEF**  
One Honey Creek Corporate Center  
125 South 84th Street, Suite 401  
Milwaukee, WI 53214-1469  
414 / 259 1500  
414 / 259 0037 fax  
www.graef-usa.com

BID ITEM NOS.	ESTIMATE OF QUANTITIES

<b>WATER MAIN</b>	SA.FKO
CONTRACTOR:	ST.FKO
MAINLINE INSPECTED BY:	W. FKO
LATERALS INSPECTED BY:	G. FKO
DATE COMPLETED:	E. FKO
TYPE OF PIPE, ASTM NO.	T. FKO
TYPE OF PIPE, ASTM NO.	I. FKO
AS-BUILTS BY:	TS.FKO
DATE:	PP.
This is to certify that this plan was approved by the Water Works and Sewer Utility Commission of Oak Creek at a regular meeting.	
Utility Engineer	Date
ADD 1	01/29/14
REVISION BY	DATE

<b>CITY OF OAK CREEK, WISCONSIN</b>				APPROVED BY	
DESIGNED BY	DATE	DRAWN BY	DATE	CHECKED BY	DATE
AS	1-16-14	FKO	1-16-14	MNP	1-16-14
<b>W. RYAN RD. TRAFFIC CONTROL STAGE 4</b> <b>IN: W. RYAN ROAD (STH 100)</b> FR: 650 FT. EAST OF S. HOWELL AVE. TO: 850 FT. WEST S. HOWELL AVE.					
CITY ENGINEER	DATE	APPROVED BY			
SCALE	SHEET				
PLAN	13				
HOR. 1"=50'	OF				
	13				
FILE NO: 14104-13C-2208					

L:\Users\13120336\OneCall\Drawings\W001\_RyanC\_06.dwg, 1/29/2014 2:10:02 PM, 1500, DWG To PDF, p.3